

RoHS Compliant

REVISIONS			
REV.	DESCRIPTION	DATE	DESIGN

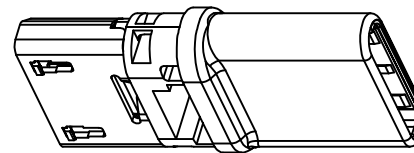
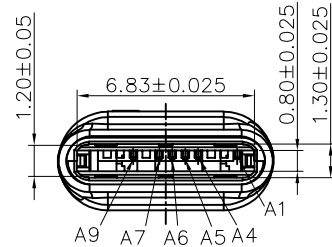
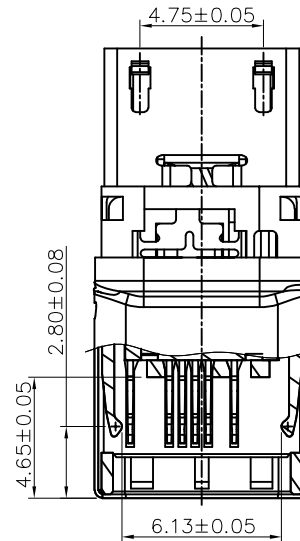
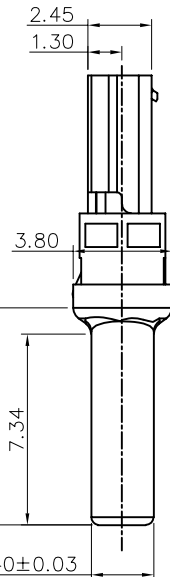
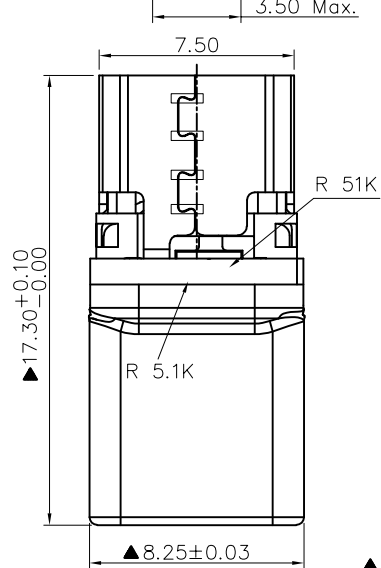
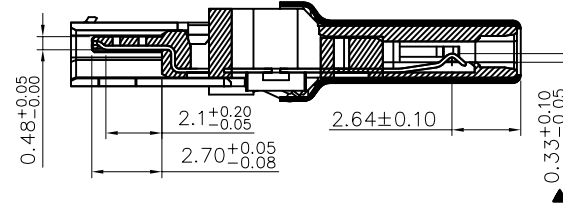
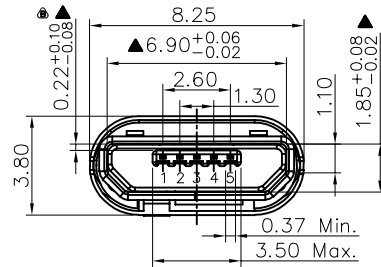

NOTE:

1. MATERIAL:
- 1.1 INSULATOR:HIGH TEMPERATURE PLASTIC LCP UL 94 V-0;BLACK
 - 1.2 CONTACT:COPPER ALLOY(T=0.15mm)
 - 1.3 MICRO USB SHELL:SUS201(T=0.30mm)
 - 1.4 USB CM SHELL:SUS361L(T=0.15mm)
 - 1.5 LATCH:SUS301 (T=0.40mm)
2. ELECTRICAL CHARACTERISTICS;
- 2.1 CONTACTRESISTANCE:80mΩ Max
 - 2.2 CONTACT CURRENT RATING:1.5 A
 - 2.3 DIELECTRIC WITHSTANDING VOLTAGE:100 V R. M. S.
 - 2.4 INSULATION RESISTANCE 100 MEGOHMS Min
 - 2.5 OPERATING TEMPERATURE:-25° C ~ 75° C
- 3 MECHANICAL CHARACTERISTICS:
- 3.1 MATING FORCE: USB CM 5~20N & MICRO USB 35N Max.
 - 3.2 UNMATED FORCE: USB CM 8~20N & MICRO USB 10N Min.
4. PLATING
- 4.1 TERMINAL CONTACT: (SEE TAB) GOLD PLATING ALL OVER 50u~MIN NICKEL
 - 4.2 SHELL:50u~MIN. NICEL ALL OVER

MICRO USB BF	PIN 1	PIN 2	PIN 3	PIN 4		PIN 5
SIGNAL NAME	VBUS	D-	D+	ID		GND
USB CM	A9	A7	A6	A5	A4	A1
SIGNAL NAME	VBUS	D-	D+	CC1	VBUS	GND

Bestcreate Technology Limited

TOLERANCES UNLESS OTHERWISE SPECIFIED:

X.	± 0.25	X.*	± 3'
.X	± 0.20	.X*	± 2'
.XX	± 0.15	.XX*	± 1'

Website:www.bsc-elec.com

Email:bestcreate@bsc-elec.com

DESIGN:
I. L

DATE:

CHECKED:
C. W

DATE:

APPROVED:
C. W

DATE:

TITLE:

USB2.0 C MALE TO MICRO USB 2.0 BF ADAPTER

MATERILA:

PART NO:

AD-20CM20BF-010

SIZE: A4

FINSH:

DWG NO:

AD-20CM20BF-010

REV: A

UNIT mm

SCALE 1=1

QUALITY SYMBOLS

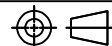

1

2

3

4

5

6

7

8