

RoHS Compliant

REVISIONS			
REV.	DESCRIPTION	DATE	DESIGN

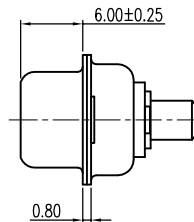
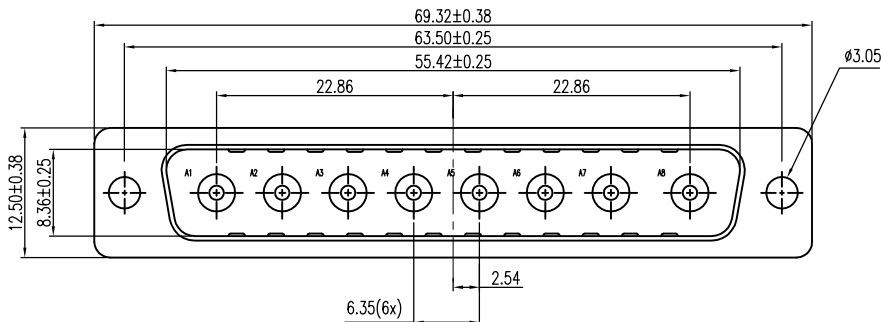

NOTE:

- MATERIALS AND FINISH
SHELL : STEEL MATERIAL, FRONT-NICKEL PLATING;BACK-TIN PLATING
CONNECTOR INSULATOR : PBT THERMOPLASTIC, 30% GLASS FILLED, UL 94V-0 RATED,
HIGH POWER CONTACT MATERIAL: BRASS
FOOTHOLD: MATERIAL:SPCC, NICKEL PLATING
- ELECTRICAL CHARACTERISTICS
HIGH POWER CONTACT CURRENT RATING : 10,20,30,OR40 AMPS
HIGH POWER CONTACT RESISTANCE : 2.7 MILLIOHMS MAX.
DIELECTRIC WITHSTANDING VOLTAGE :
1000 V AC FOR 1 MINUTE
INSULATION RESISTANCE : 5000 MEGAOHMS MIN.
TEMPERATURE RATING : -55°C ~ +125°C
- HOW TO ORDER:

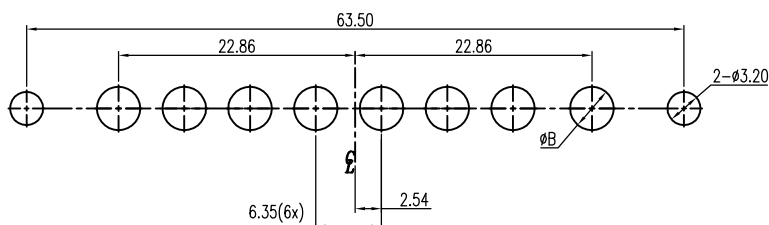
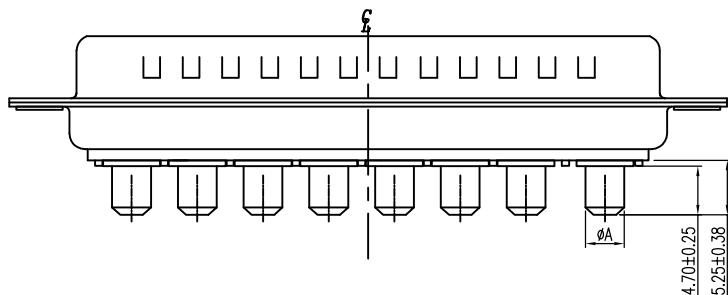

RECOMMENDED P.C.B LAYOUT

40A	φ3.75	φ4.20
30A	φ3.20	φ3.75
20A	φ2.80	φ3.28
10A	φ1.70	φ2.20
Current Rating	φA	φB
	Dimension	Dimension

DH141-088GX1BP-AOX10

- 1: Male, 10A
- 3: Male, 20A
- 5: Male, 30A
- 7: Male, 40A

4: Current terminal,T/H

088: 8W8

G: Full Gold

- 1:1u" 5: 5u"
- 2:2u" 6: 10u"
- 3:3u" 7: 15u" 8: 30u"

1: Front NI Back SN

0: RoHS

- 2: Front rivet hollow nut(Copper)
- 1: Back rivet hollow nut(Copper)
- 0: φ3.05 through Hole

P: PBT

B: Black

Bestcreate Technology Limited

TOLERANCES UNLESS OTHERWISE SPECIFIED:

.X	± 0.38	X.	± 3"
.XX	± 0.25	.X"	± 2"
.XXX	± 0.15	.XX"	± 1"

Website: www.bsc-elec.com
Email: bestcreate@bsc-elec.com

DESIGN:

I.L

CHECKED:

C.W

APPROVED:

C.W

DATE:

2017.3.1

DATE:

2017.3.1

DATE:

2017.3.1

TITLE:

8W7 MALE CONNECTOR 180D PCB MOUNT

MATERILA:

FINSH:

PART NO:

DWG NO:

DH141-088GX1BP-AOX10

DH141-088GX1BP-AOX10

SIZE: A4

REV: A

UNIT mm

SCALE 1=1

QUALITY SYMBOLS

