

RoHS Compliant

REVISIONS			
REV.	DESCRIPTION	DATE	DESIGN

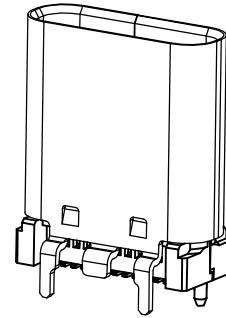
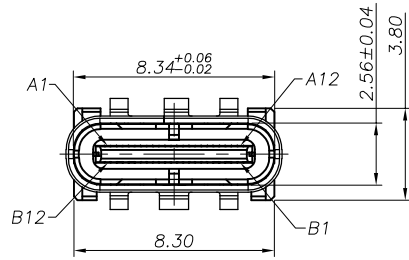

- NOTE:
- MATERIAL SPECIFICATION:
    - HOUSING: HIGH TEMPERATURE RESISTANT PLASTIC, UL94 V-0
    - TERMINAL: COPPER ALLOY (C1814)
    - MID PLATE: STAINLESS STEEL (SUS301)
    - FRONT SHELL: STAINLESS STEEL (SUS304)
    - EMI PLATE: STAINLESS STEEL (SUS304)
  - PLATING SPECIFICATION:
    - TERMINAL:
      - Ni 50u" MIN. UNDER PLATED OVER ALL.
      - Au PLATED ON THE FUNCTIONAL AREA OF CONTACT. (GOLD PLATING THICKNESS FOLLOW THE P/N)
      - PLATING SPECIFICATIONS OF THE SOLDER AREA FOLLOW THE P/N
    - FRONT SHELL:
      - PLATING SPECIFICATIONS FOLLOW THE P/N
    - MID PLATE & EMI PLATE:
      - CLEAR ONLY
  - MECHANICAL PERFORMANCE,
    - INSERTION FORCE: 0.5~2.0kgf.
    - REMOVAL FORCE: 0.8kgf~2.0kgf.
    - DURABILITY: 10000 CYCLES.
  - ELECTRICAL PERFORMANCE,
    - VOLTAGE RATING: 5 V DC/AC (RMS. max)  
CURRENT RATING: 5 AMPS. FOR TOTAL VBUS/GND PINS;  
1.25AMPS FOR CC PIN, 0.25 AMPS. FOR ALL OTHER CONTACT.
    - LLCR:
      - VBUS & GND PINS AND OTHER PINS: 40mΩ/PIN MAX.
      - SHIELD: 50mΩ/MAX.
      - LLCR MAX. CHANGE OF ALL PINS: 10mΩ.
    - INSULATION RESISTANCE: 100MΩ MIN
    - DIELECTRIC WITHSTAND VOLTAGE, AC 100V FOR 1 MINUTE.
  - ENVIRONMENTAL PERFORMANCE:
    - OPERATING TEMPERATURE: -25°C~+85°C.
  - IR REFLOW:
    - THE PEAK TEMPERATURE ON THE BOARD SHALL BE MAINTAINED FOR 10 SECONDS AT 260°C.

A

A

B

B

C

C

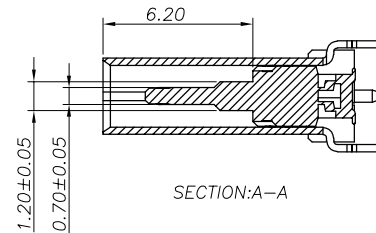
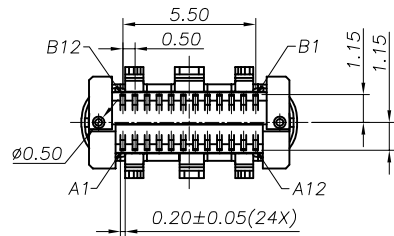
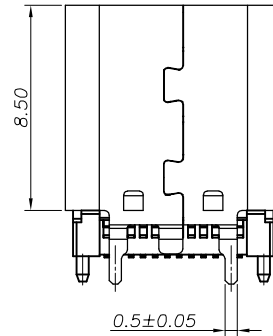
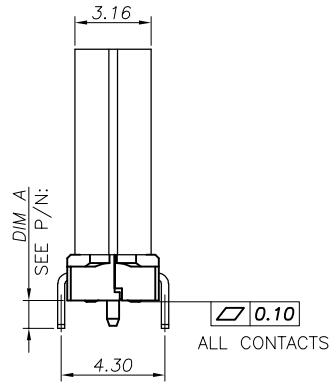
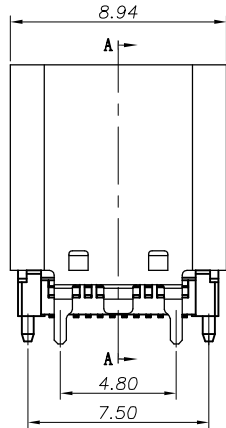

PART NO. INFORMATION

**U06-C F 2 X 5 R - 002 - AXV3**

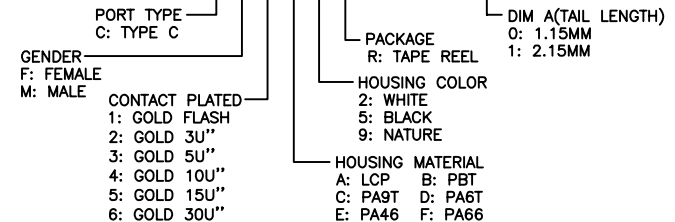

D

D

**Bestcreate Technology Limited**

TOLERANCES UNLESS OTHERWISE SPECIFIED:		DESIGN: I. L	DATE: 2017. 3. 1	TITLE: USB CF VERTICAL (L=10.35)			
X.	± 0.30	X.'	± 10'	MATERILA:	PART NO: U06-CF2C5R-002-AXV3		
.X	± 0.20	.X'	± 8'			FINSH:	DWG NO: U06-CF2C5R-002-AXV3
.XX	± 0.10	.XX'	± 5'				
Website: www.bsc-elec.com	APPROVED: C. W	DATE: 2017. 3. 1	SIZE: A4				
E-mail: bestcreate@bsc-elec.com							

REV: A	UNIT: mm	SCALE: 1=1	QUALITY SYMBOLS
--------	----------	------------	-----------------

RoHS Compliant

REVISIONS			
REV.	DESCRIPTION	DATE	DESIGN

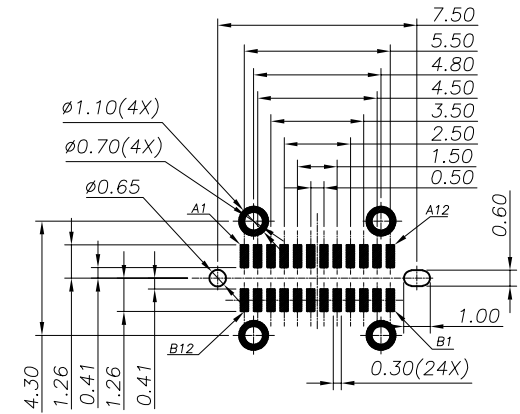
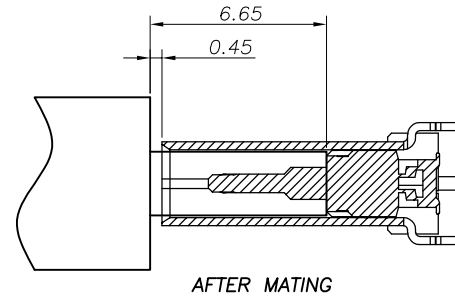
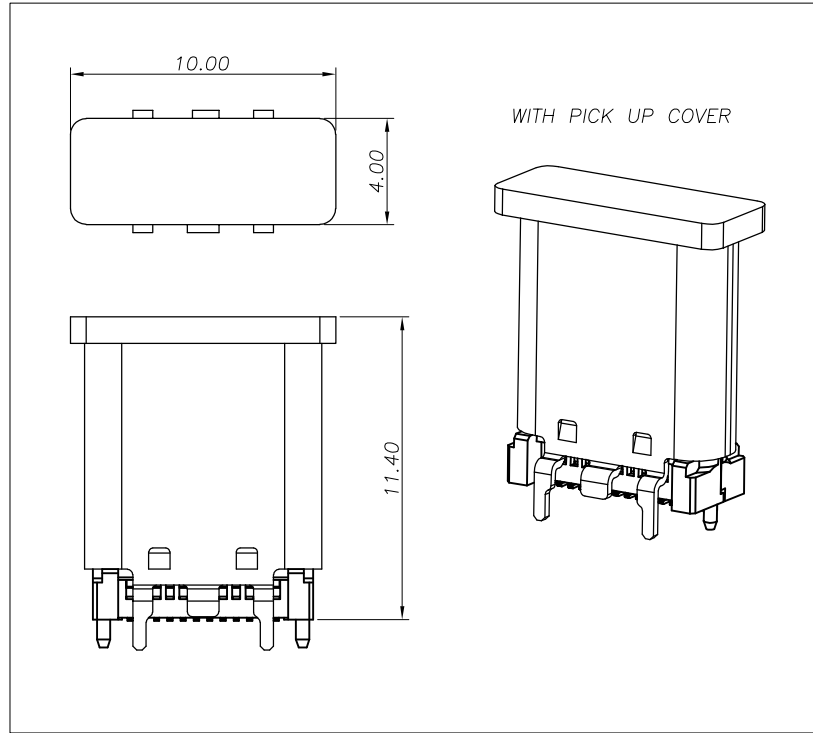

RECOMMENDED PCB LAYOUT(TOP VIEW)  
THICKNESS 1.0±0.10MM;DEFAULT TOLERANCE:±0.05

USB TYPE-C PIN ASSIGNMENTS

PIN NUMBER	SIGNAL NAME	PIN NUMBER	SIGNAL NAME
A1	GND	B12	GND
A2	SSTXp1	B11	SSRXp1
A3	SSTXn1	B10	SSRXn1
A4	Vbus	B9	Vbus
A5	CC1	B8	SBU2
A6	Dp1	B7	Dn2
A7	Dn1	B6	Dp2
A8	SBU1	B5	CC2
A9	Vbus	B4	Vbus
A10	SSRXn2	B3	SSTXn2
A11	SSRXp2	B2	SSTXp2
A12	GND	B1	GND

PART NO. INFORMATION

**U06-C F 2 X 5 R - 002 - AXV3**

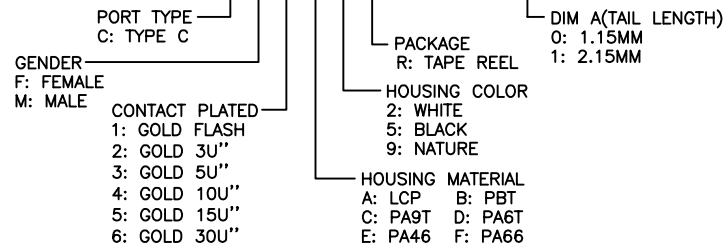

**Bestcreate Technology Limited**

TOLERANCES UNLESS OTHERWISE SPECIFIED:

X.	± 0.30	X.'	± 10'
.X	± 0.20	.X''	± 8''
.XX	± 0.10	.XX'''	± 5'''

DESIGN: I. L. DATE: 2017. 3. 1

CHECKED: C. W. DATE: 2017. 3. 1

APPROVED: C. W. DATE: 2017. 3. 1

TITLE: USB CF VERTICAL (L=10.35)

MATERIAL:	PART NO: U06-CF2C5R-002-AXV3	SIZE: A4
FINISH:	DWG NO: U06-CF2C5R-002-AXV3	SHEET: 2 OF 3

REV: A	UNIT mm	SCALE 1=1	QUALITY SYMBOLS
--------	---------	-----------	-----------------

Website: www.bsc-elec.com  
E-mail: bestcreate@bsc-elec.com

RoHS Compliant

REVISIONS			
REV.	DESCRIPTION	DATE	DESIGN

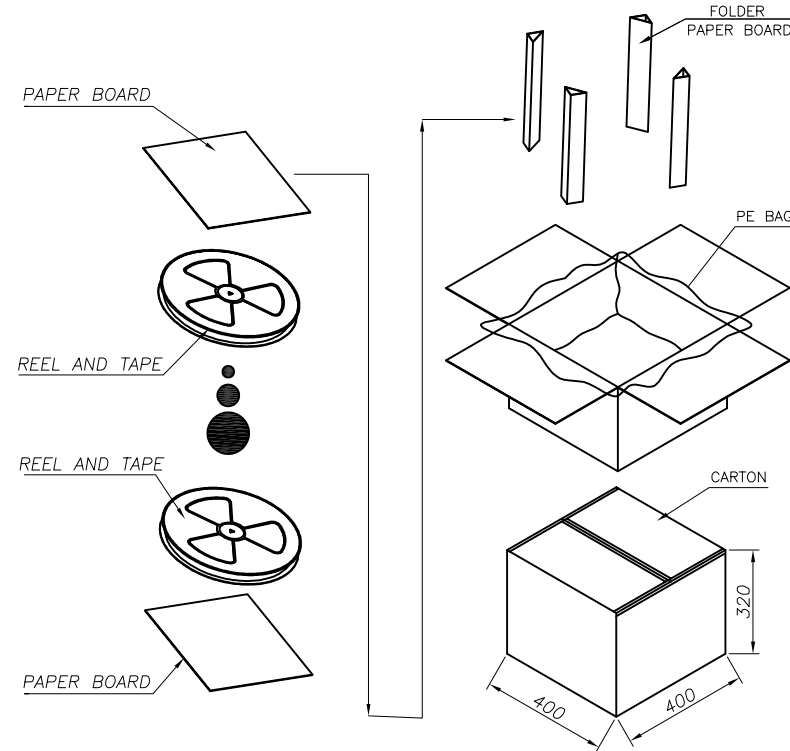
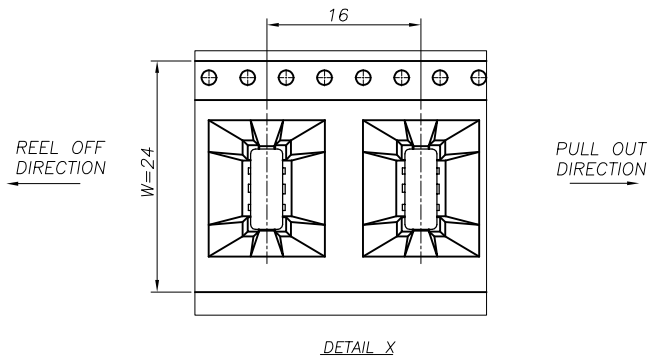
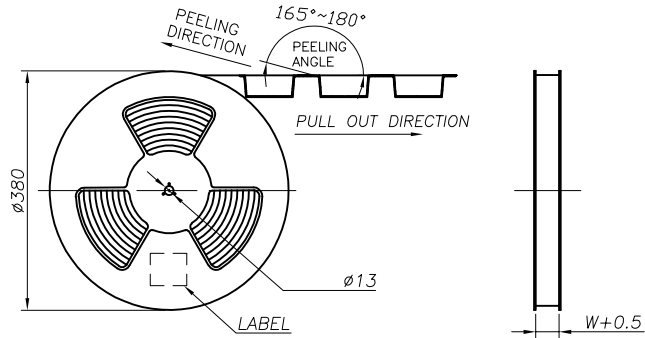
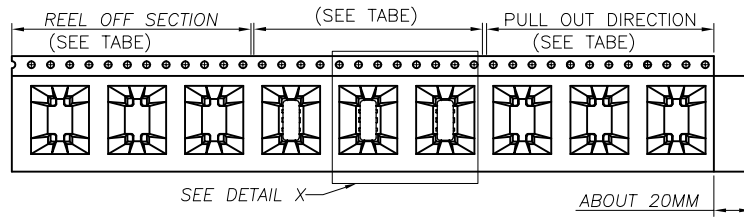

TABE

U06-CF1X5R-002-A0V3	18PCS	18PCS	450PCS	4500PCS
P / N:	REEL OFF SECTION	PULL OUT DIRECTION	REEL	CARTON

**Bestcreate Technology Limited**

TOLERANCES UNLESS OTHERWISE SPECIFIED:

X.	$\pm 0.30$	X.*	$\pm 10^{\circ}$
.X	$\pm 0.20$	.X*	$\pm 8^{\circ}$
.XX	$\pm 0.10$	.XX*	$\pm 5^{\circ}$

Website: [www.bsc-elec.com](http://www.bsc-elec.com)

E-mail: [bestcreate@bsc-elec.com](mailto:bestcreate@bsc-elec.com)

DESIGN:

I. L

DATE:

2017. 3. 1

CHECKED:

C. W

DATE:

2017. 3. 1

APPROVED:

C. W

DATE:

2017. 3. 1

TITLE:

**USB CF VERTICAL (L=10.35)**

MATERILA:

FINSH:

PART NO:

DWG NO:

SIZE:

SHEET:

U06-CF2C5R-002-AXV3

U06-CF2C5R-002-AXV3

A4

3 OF 3

REV: A

UNIT mm

SCALE 1=1

QUALITY SYMBOLS

1

2

3

4

5

6

7

8