

RoHS Compliant

REVISIONS			
REV.	DESCRIPTION	DATE	DESIGN

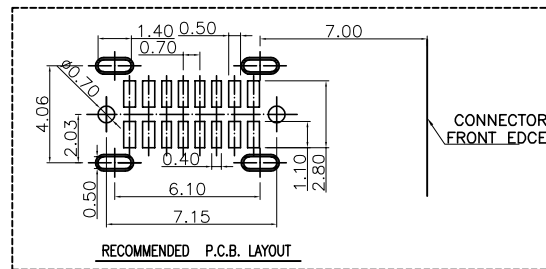
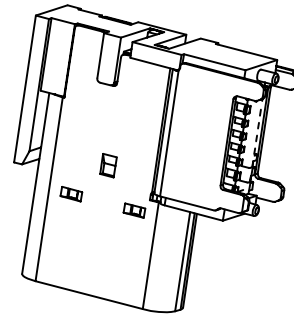
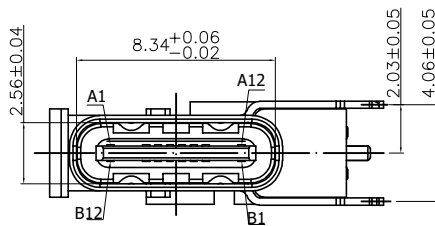
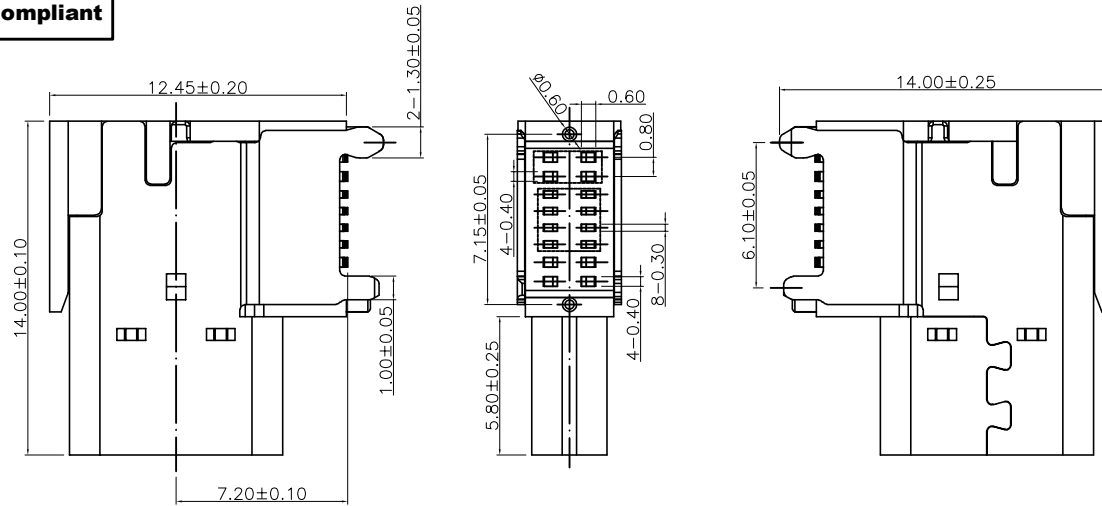

NOTES:

- ELECTRICAL
 - RATED CURRENT: 3.0A
 - CONTACT RESISTANCE: 30 MILLIOHMS MAX
 - WITHSTAND VOLTAGE: 150V AC / 1 mA MAX
 - INSULATION RESISTANCE: 150V DC/100 MEGA OHMS MIN
- MECHANICAL:
 - MATING FORCE: 5-20N
 - UNMATING FORCE: 8-20N
 - LIFETIME: 10000次
- MATERIAL
 - HOUSING: LCP+30%G.F黑色 UL94V-0
 - CONTACT: C2680 T=0.15MM
 - SHELL: SUS201 T=0.30MM
 - HOOK: SUS201 T=0.12MM
- PLATING:FINISH
 - CONTACT: AU 1U" ON CONTACT AREA
GOLD PLATED ON WELDING AREA.
 - SHELL: MATTE TIN PLATED 40U"MIN (SALT SPRY 24H)
- TIN STICKING TEST IS NECESSARY FOR ELECTROPLATE: COVER 95% MIN
- SMT REFLOW SOLDERING (260° C±5° C) WITHOUT BLISTER, COLLOSOL, DISCOLOR (DISTORTED SHOULD BE WITHIN TOLDERANCE)
- WORKING TEMPERATURE: -55° C~+85° C
- SALT SPRAY TEST:

THERE IS NO RUST AFTER 24HOURS SALT SPRAY TEST BY BRINE CONCENTRATION 5±1% ;
- CONTROLLING CRITICAL DIMENSIONS.

A1	GND	B12	GND
A2		B11	
A3		B10	
A4	VBUS	B9	VBUS
A5	CC1	B8	SBU2
A6	DP1	B7	DN2
A7	DN1	B6	DP2
A8	SBU1	B5	CC2
A9	VBUS	B4	VBUS
A10		B3	
A11		B2	
A12	GND	B1	GND

PART NO. INFORMATION

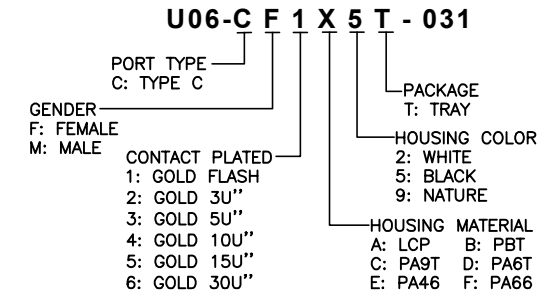

Bestcreate Technology Limited

TOLERANCES UNLESS OTHERWISE SPECIFIED:

X.	±	0.50	X.*	±	3'
.X	±	0.25	.X*	±	2'
.XX	±	0.15	.XX*	±	1'

Tel/Whatsapp:0086-13712299763
Skype: belle.wu3340

DESIGN:

I. L 2017. 3. 1

CHECKED:

C. W 2017. 3. 1

APPROVED:

C. W 2017. 3. 1

DATE:

DATE:

DATE:

TITLE:

UPRIGHT USB TYPE CF 16PIN SMT CH=7.20

MATERILA:

FINSH:

PART NO:

DWG NO:

U06-CF1X5T-031

U06-CF1X5T-031

SIZE:

A4

REV: A

UNIT mm

SCALE 1=1

QUALITY SYMBOLS

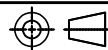

1

2

3

4

5

6

7

8

RoHS Compliant

REVISIONS			
REV.	DESCRIPTION	DATE	DESIGN

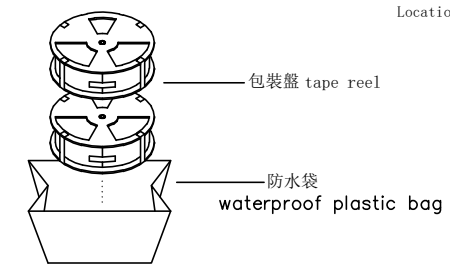
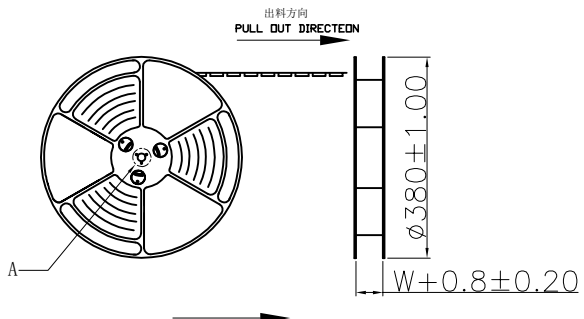

at small positioning hole of the carrier tape side.
標簽黏貼處 (朝捲裝包材的小定位孔一側)
Location of label sticking (label)

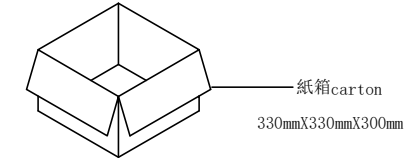
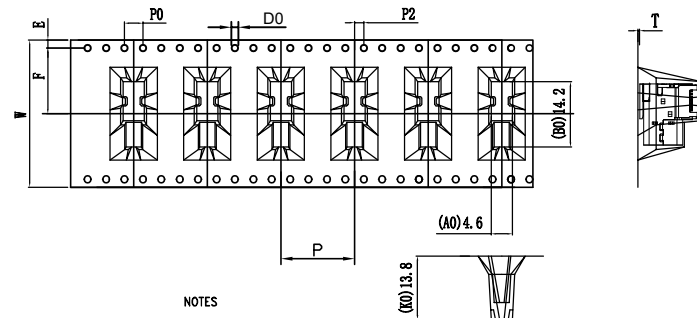
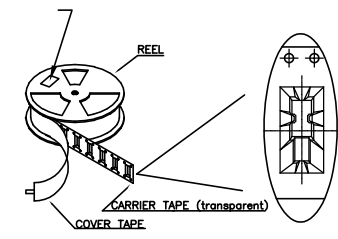

NOTE:
1. 每捲包裝數量及每箱裝箱數量如左下表格。
Packing q'ty of each reel & carton as below table shown.
2. 將裝滿產品的卷盤放入紙箱並以膠帶封口
Put reels in the carton and use adhesive tape to seal up.

NOTES
1. 帶子引導長度
LEAD TAPE LENGTH
出料方向
PULL OUT DIRECTION



2. 上帶 剝力力為: 0.1~1.3N(10.2gf~130gf)
PEELING OFF FORCE OF TOP TAPE: 0.1~1.3N(10.2gf~130gf)
出貨運輸過程中一定注意:
THIS REQUIREMENT SHOULD BE APPLIED AT SHIPMENT:
卷帶在運輸過程中不能散開
PEELING OFF SHOULD NOT BE ALLOWED DURING TRANSPORTATION

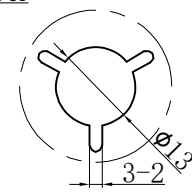
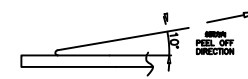

DETAIL: A
10:1

卷帶	規格: $\phi 330\text{mm}$	包裝數量: 400PCS
紙箱	規格: 330mmX330mmX300mm	包裝數量: 8盤 / 3200PCS

W	32 ± 0.3
F	14.2 ± 0.1
S0	± 0.1
T	0.50 ± 0.1
E	1.75 ± 0.1
P	16.0 ± 0.1
P0	4 ± 0.1
P2	2 ± 0.15
AO	4.60 ± 0.1
BO	14.2 ± 0.1
KO	13.8 ± 0.1
DO	1.50 ± 0.1

Bestcreate Technology Limited

TOLERANCES UNLESS OTHERWISE SPECIFIED:			
X.	±	0.50	X.' ± 3'
.X	±	0.25	.X' ± 2'
.XX	±	0.15	.XX' ± 1'

Tel/Whatsapp:0086-13712299763
Skype: belle.wu3340

DESIGN:	DATE:
I. L	2017. 3. 1
CHECKED:	DATE:
C. W	2017. 3. 1
APPROVED:	DATE:
C. W	2017. 3. 1

TITLE: UPRIGHT USB TYPE CF 16PIN SMT CH=7.20		
MATERILA:	PART NO: U06-CF1X5T-031	SIZE: A4
FINSH:	DWG NO: U06-CF1X5T-031	

REV: A	UNIT mm	SCALE 1=1	QUALITY SYMBOLS
-----------	------------	--------------	-----------------