

RoHS Compliant

REVISIONS			
REV.	DESCRIPTION	DATE	DESIGN

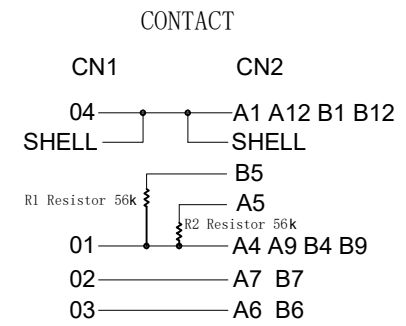
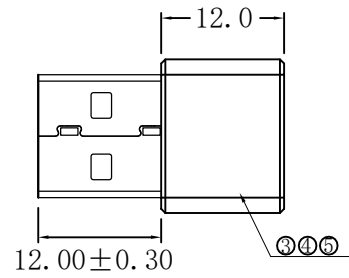
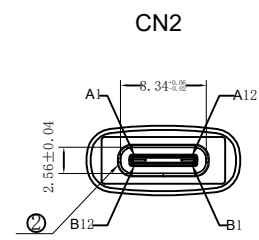
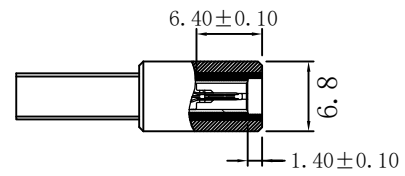
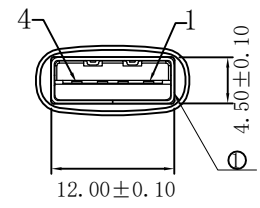
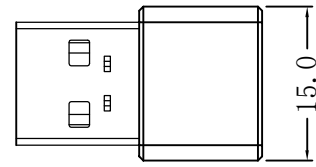

5	SHELL	Aluminium Alloy	1PCS
4	Internal Mold	PVC 45P BLACK	1.0G
3	In-Connection	PCB T=1.0MM 2*Resistor56K	1PCS
2	Connector	USB TYPE CF SHELL NICKEL PLATED PIN G/F	1PCS
1	Connector	USB 2.0 AM SHELL NICKEL PLATED PIN G/F BLACK	1PCS
NO	NAME	MATERIAL	QTY

NOTES:
 1. 100% open short test condition;
 2. Conductor Resistance $\leq 5 \Omega$, insulation resistance $\geq 10M \Omega$.
 High voltage test, DC 300V/10mS.
 3. Support Power Charging、Data Transfer.
 4. PCB Board Connection.

Bestcreate Technology Limited			TOLERANCES UNLESS OTHERWISE SPECIFIED:		DESIGN: I.L	DATE: 2017.3.1	TITLE: USB2.0 AM TO TYPE CF 24MM		
			X. ± 0.50	X.* ± 5*	CHECKED: C.W	DATE: 2017.3.1	MATERIAL:	PART NO: AD20AMCF-018	SIZE: A4
REV: A	UNIT: mm	SCALE: 1=1	QUALITY SYMBOLS	Website: www.bsc-elec.com	APPROVED: C.W	DATE: 2017.3.1	FINISH:	DWG NO: AD20AMCF-018	
.X ± 0.30	.X* ± 2*	.XX ± 0.10	.XX* ± 1*	Email: bestcreate@bsc-elec.com					