

RoHS Compliant

REVISIONS			
REV.	DESCRIPTION	DATE	DESIGN

RoHS

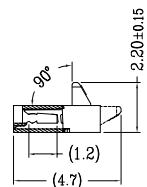
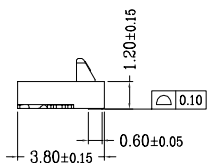
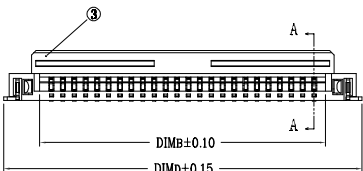
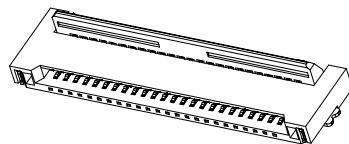
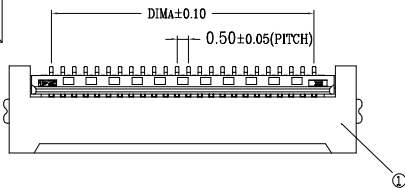

SECTION A-A

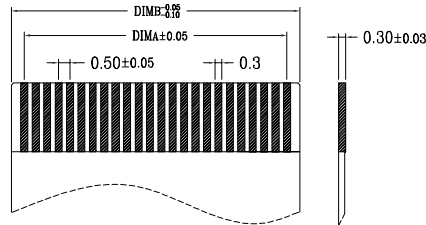
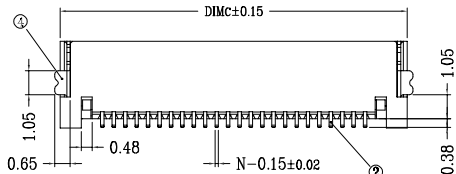

适用扁平线

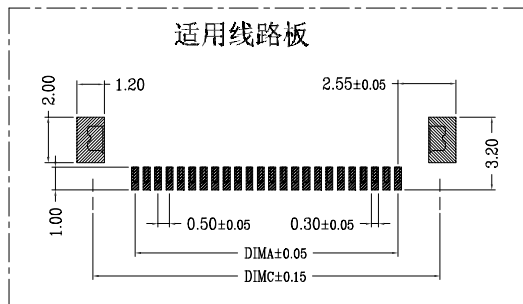

适用线路板

技术指标:

1. 塑件表面应光洁、无毛边、无明显收缩、缺陷、裂纹等现象。
2. 温度范围: -25° C~85° C.
3. 额定电压: 50V, AC/DC(等效).
4. 接触电阻: ≤0.03Ω.
5. 绝缘电阻: ≥500MΩ

CKT	DIM-A	DIM-B	DIM-C	DIM-D
4	1.50	2.52	5.20	5.68
5	2.00	3.02	5.70	6.18
6	2.50	3.52	6.20	6.68
7	3.00	4.02	6.70	7.18
8	3.50	4.52	7.20	7.68
9	4.00	5.02	7.70	8.18
10	4.50	5.52	8.20	8.68
11	5.00	6.02	8.70	9.18
12	5.50	6.52	9.20	9.68
13	6.00	7.02	9.70	10.18
14	6.50	7.52	10.20	10.68
15	7.00	8.02	10.70	11.18
16	7.50	8.52	11.20	11.68
17	8.00	9.02	11.70	12.18
18	8.50	9.52	12.20	12.68
19	9.00	10.02	12.70	13.18
20	9.50	10.52	13.20	13.68
21	10.00	11.02	13.70	14.18
22	10.50	11.52	14.20	14.68
23	11.00	12.02	14.70	15.18
24	11.50	12.52	15.20	15.68
25	12.00	13.02	15.70	16.18
26	12.50	13.52	16.20	16.68
27	13.00	14.02	16.70	17.18
28	13.50	14.52	17.20	17.68
29	14.00	15.02	17.70	18.18
30	14.50	15.52	18.20	18.68
31	15.00	16.02	18.70	19.18
32	15.50	16.52	19.20	19.68
33	16.00	17.02	19.70	20.18
34	16.50	17.52	20.20	20.68
35	17.00	18.02	20.70	21.18
36	17.50	18.52	21.20	21.68
37	18.00	19.02	21.70	22.18
38	18.50	19.52	22.20	22.68
39	19.00	20.02	22.70	23.18
40	19.50	20.52	23.20	23.68
41	20.00	21.02	23.70	24.18
42	20.50	21.52	24.20	24.68
43	21.00	22.02	24.70	25.18
44	21.50	22.52	25.20	25.68
45	22.00	23.02	25.70	26.18
46	22.50	23.52	26.20	26.68
47	23.00	24.02	26.70	27.18
48	23.50	24.52	27.20	27.68
49	24.00	25.02	27.70	28.18
50	24.50	25.52	28.20	28.68
51	25.00	26.02	28.70	29.18
52	25.50	26.52	29.20	29.68
53	26.00	27.02	29.70	30.18
54	26.50	27.52	30.20	30.68
55	27.00	28.02	30.70	31.18
56	27.50	28.52	31.20	31.68
57	28.00	29.02	31.70	32.18
58	28.50	29.52	32.20	32.68
59	29.00	30.02	32.70	33.18
60	29.50	30.52	33.20	33.68

PART NO. INFORMATION

FPC05-XX 0 1 X - B006

NO. OF CONTACTS  
 PLATING  
 0: TIN  
 G: GOLD FLASH  
 PACKAGE  
 T:TUBE  
 R:TAPE&REEL  
 1:ROHS  
 2: HALOGEN FREE

Bestcreate Technology Limited

TOLERANCES UNLESS OTHERWISE SPECIFIED:

.X	± 0.50	X'	± 2'
.XX	± 0.20	.X'	± 1'
.XXX	± 0.05	.XX'	± 0.5'

Website:www.bsc-elec.com  
 Email:bestcreate@bsc-elec.com

DESIGN: I. L DATE: 2017. 3. 1  
 CHECKED: C. W DATE: 2017. 3. 1  
 APPROVED: C. W DATE: 2017. 3. 1

TITLE: 0.5MM FPC BACK LOCK HORIZONTAL TYPE, H:1.2MM

MATERILA: PART NO: FPC05-XXX1X-B006 SIZE: A4  
 FINSH: DWG NO: FPC05-XXX1X-B006

REV: A UNIT mm SCALE 1=1 QUALITY SYMBOLS