

RoHS Compliant

REVISIONS			
REV.	DESCRIPTION	DATE	DESIGN

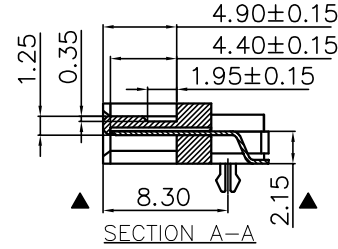
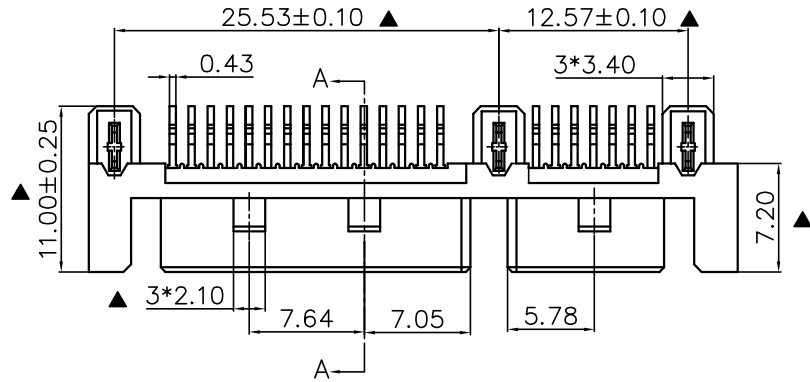

SPECIFICATION:

1. MATERIAL:
 HOUSING: LCP LG431-9731L 30% G/F UL 94V-0
 COLOR: BLACK
 CONTACT: BRASS C2680R-H,T=0.25mm
 PEG: BRASS C2680R-H,T=0.30mm
2. FINISH:
 CONTACT: 1u" GOLD/TIN PLATING ON CONTACT AREA
 100u" MIN. TIN PLATING ON SOLDER TAILS
 50u" MIN. NICKEL UNDERPLATING OVER ALL
3. ELECTRICAL
 CURRENT RATING: 1.5A PER PIN MIN.
 CONTACT RESISTANCE: 30m OHM MAX.
 INSULATION RESISTANCE: 1000M OHM MIN.
 DIELECTRIC WITHSTANDING VOLTAGE: 500VAC.

PART NO. INFORMATION

S715 - M X A 5 T -001 -V1

GENDER
 F: FEMALE
 M: MALE

CONTACT PLATED
 1: GOLD FLASH/TIN
 2: 15U" GOLD/TIN
 3: 30U" GOLD/TIN

PACKAGE
 T: TRAY R: TAPE REEL

HOUSING COLOR
 5: BLACK

HOUSING MATERIAL
 A: LCP

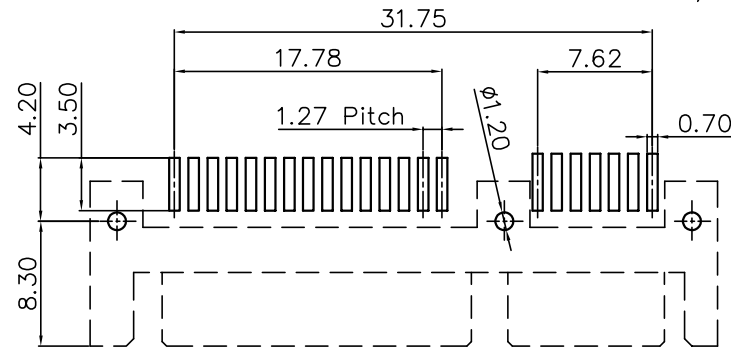
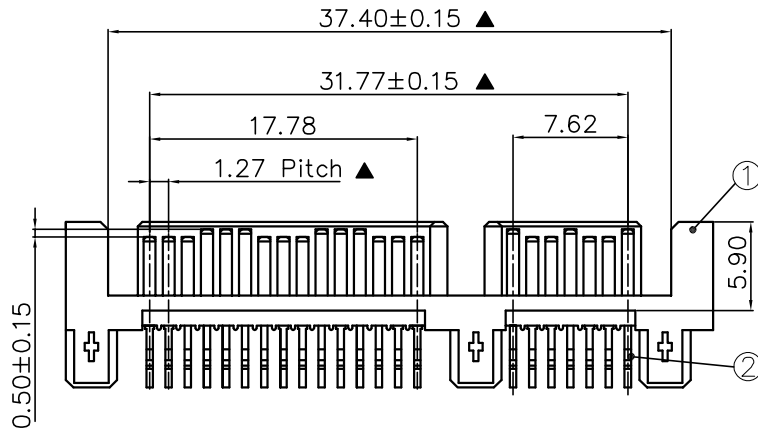
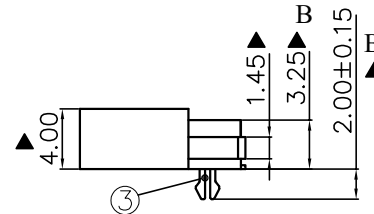
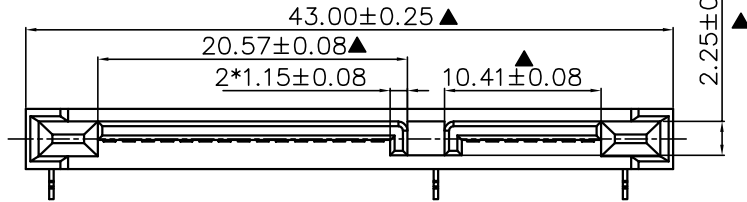

RECOMMENDED PCB TOLERANCE: ±0.05

NO.	DESCRIPTION	MATERIAL	COLOR	REMARK
3	Board lock	Brass C2680		Gold/Ni Plated
2	Terminal	Brass C2680		Gold/Tin Plated
1	Housing	High Temp	Black	UL 94V-0

Bestcreate Technology Limited

TOLERANCES UNLESS OTHERWISE SPECIFIED:

X.	± 0.30	X.'	± 3'
.X	± 0.20	.X'	± 2'
.XX	± 0.15	.XX'	± 1'

Website: www.bsc-elec.com

E-mail: bestcreate@bsc-elec.com

DESIGN: I.L DATE: 2017.3.1

CHECKED: C.W DATE: 2017.3.1

APPROVED: C.W DATE: 2017.3.1

TITLE: SATA 7+15P 公座 SMT 鱼叉型

MATERIAL: PART NO: S715-MXA5T-001-V1 SIZE: A4

FINISH: DWG NO: S715-MXA5T-001-V1 SHEET: 1 OF 1

REV:	UNIT	SCALE	QUALITY SYMBOLS
A	mm	1=1	