

RoHS Compliant

REVISIONS			
REV.	DESCRIPTION	DATE	DESIGN

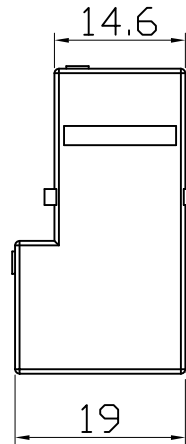
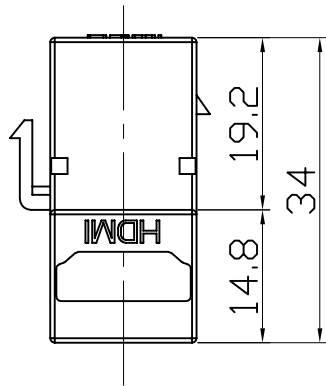
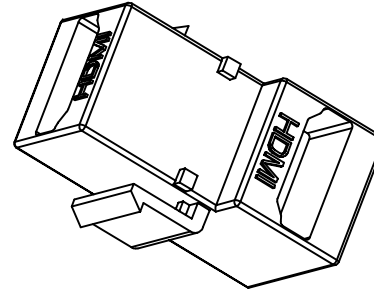
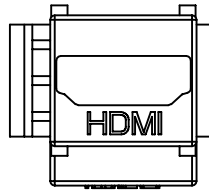

R0.5  
NOTE :

- 1.SPECIFICATION:
- 1.1.CURRENT RATING: 0.5 Amp Max.
  - 1.2.VOLTAGE RATING: 40 V ac(r.m.s) Max.
  - 1.3.CONTACT RESISTANCE: 10m ohms Max.mated
  - 1.4.INSULATION RESISTANCE:100M ohms Min.
  - 1.5.DIELECTRIC WITHSTANDING VOLTAGE:  
AC 500V Min. (for 1 minute)
  - 1.6.OPERATION TEMPERATURE RANGE: -25°C~85°C
- 2.MECHANICAL
- 2.1 INSERTION FORCE: 4.5KGF MAXMUM
  - 2.1 WITHDRAWAL FORCE:1.0KGF MINIMUM; 4.0KGF MAXMUM

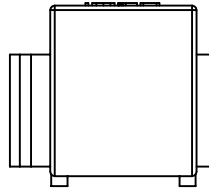
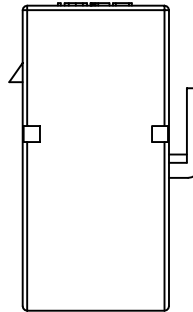

**Bestcreate Technology Limited**

TOLERANCES UNLESS OTHERWISE SPECIFIED:

x.	± 0.50	X'	± 5'
.X	± 0.30	.X'	± 2'
.XX	± 0.10	.XX'	± 1'

Website:www.bsc-elec.com  
Email:bestcreate@bsc-elec.com

DESIGN:	DATE:	2017.3.1
I.L	DATE:	2017.3.1
CHECKED:	DATE:	2017.3.1
C.W	DATE:	2017.3.1
APPROVED:	DATE:	2017.3.1
C.W	DATE:	2017.3.1

TITLE: HDMI 19P A FEMALE TO A FEMALE ADAPTER 90°		
MATERILA:	PART NO: ADHD19AFT010AF-002	SIZE: A4
FINSH:	DWG NO: ADHD19AFT010AF-002	

REV: A	UNIT mm	SCALE 1=1	QUALITY SYMBOLS 
-----------	------------	--------------	---------------------