

RoHS Compliant

REVISIONS			
REV.	DESCRIPTION	DATE	DESIGN

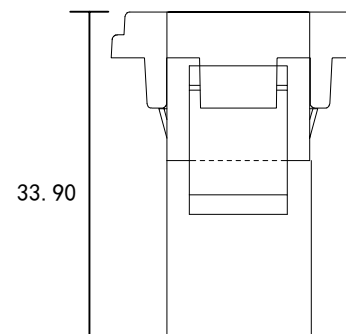
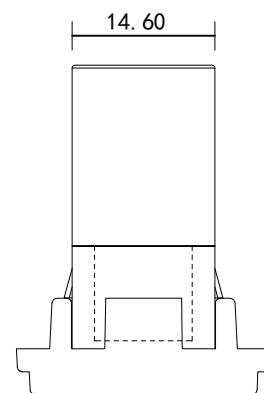
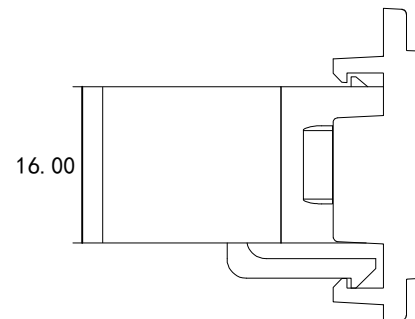
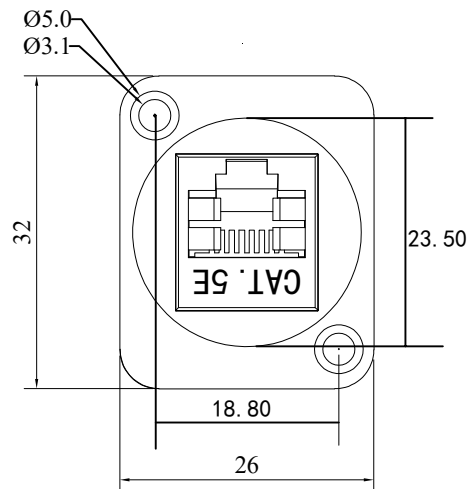
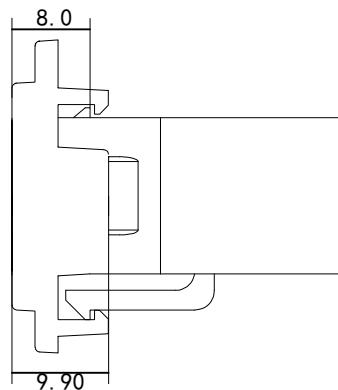

DESCRIPTION OF PRODUCTS:

1. APPLY TO THE CONNECTION OF COMMUNICATION SOCKET BETWEEN EQUIPMENT AND WORKING AREA FOR SIGNAL TRANSMISSION
2. INTERNAL STRUCTURE IS COMPACT, BRIEF OUTWARD, ELEGANT APPEARANCE.
3. LIFETIME: 750CYCLES
4. CONTACT RESISTANCE $\leq 2.5M\Omega$
5. PRESSURE RESISTANCE: DC700V 1MIN
6. INSULATION RESISTANCE $\geq 1000\Omega$
7. HOUSING: ABS ROHS
8. TERMINAL: CAROBRONZE T=0.35MM
9. FLANGE WITH HOLE: ZINC ALLOY WITH NICKEL PLATING ON SURFACE

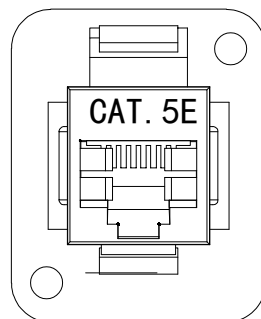

Bestcreate Technology Limited

TOLERANCES UNLESS OTHERWISE SPECIFIED:

X.	± 0.35	X'.	± 3'
.X	± 0.30	.X'	± 2'
.XX	± 0.25	.XX'	± 1'

Website: www.bsc-elec.com
Email: bestcreate@bsc-elec.com

DESIGN: I. L DATE: 2017. 3. 1

CHECKED: DATE: C. W 2017. 3. 1

APPROVED: DATE: C. W 2017. 3. 1

TITLE: RJ45 CAT. 5E SEMI-CONDUCTIVE CONNECTOR PANEL MOUNT DUAL PORT, L=34MM

MATERILA:	PART NO: SC-S-5866-CAT-5E-34MM	SIZE: A4
FINSH:	DWC NO: SC-S-5866-CAT-5E-34MM	

REV: A	UNIT mm	SCALE 1=1	QUALITY SYMBOLS	
--------	---------	-----------	-----------------	--