

RoHS Compliant

REVISIONS

REV.	DESCRIPTION	DATE	DESIGN

Features:

- 1.2~8 circuits available;
- 2.Material:PA66 UL 94V-0;
- 3.Accepts H350011 terminal;
- 4.Mates with H3500S13,H3500S14,H3500S16 header;
- 5.Coloe: Black/Natural

Specification:

Current rating:14A at 16A.

Voltage rating:400V AC(RMS) or 400V DC Max.

Contact resistance:10mΩ Max.

Insulation resistance:100MΩ Min.

Withstanding voltage:1800VAC/minute.

Ambient temperature range: -40°C~105°C.

Dimensional infotmation(mm)

Circuits	DIM A	DIM B
2	3.50	8.00
3	7.00	11.50
4	10.50	15.00
5	14.00	18.50
6	17.50	22.00
7	21.00	25.50
8	24.50	29.00

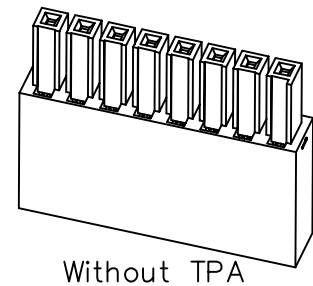
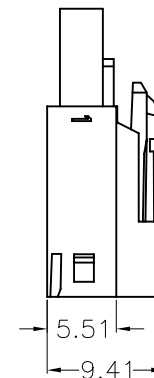
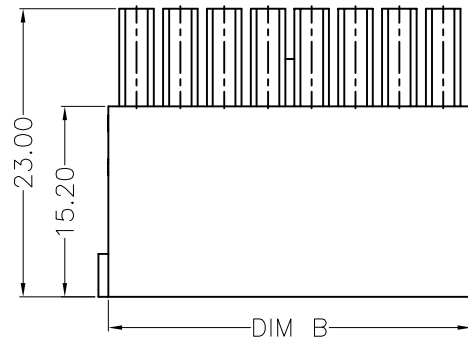
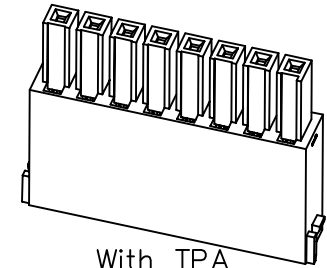
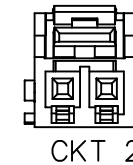
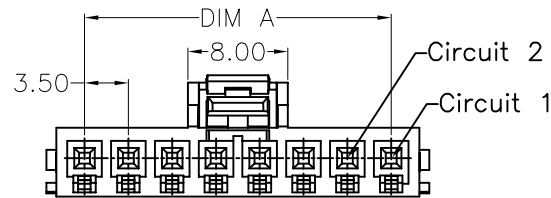

PART NO. INFORMATION

H3500S12-XX-XX-X

SERIES NO:

PIN Q' PY:

02~08

TPA:

00:Without TPA

0E:With TPA

A-BLACK (A KEY)

B-NATURE (B KEY)

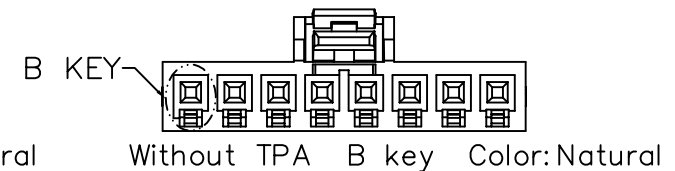
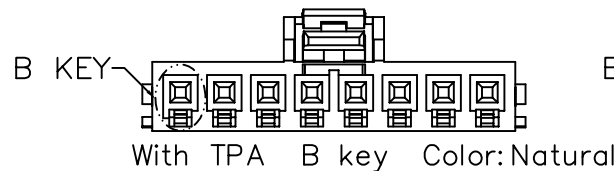
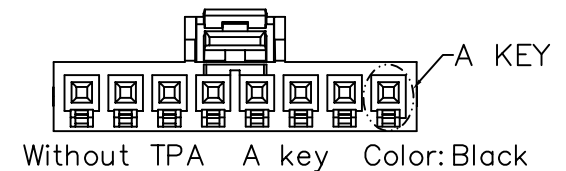
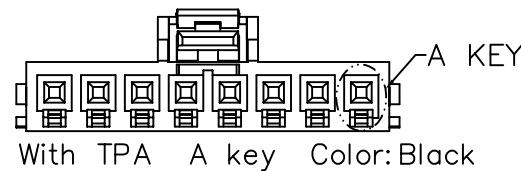

Bestcreate Technology Limited

TOLERANCES UNLESS OTHERWISE SPECIFIED:

.X	±	0.40	X.*	±	3"
.XX	±	0.25	.X*	±	2"
.XXX	±	0.15	.XX*	±	1"

Website:www.bsc-elec.com

Email:bestcreate@bsc-elec.com

DESIGN:

DATE:

I. L

2018.3.5

CHECKED:

DATE:

C. W

2018.3.5

APPROVED:

DATE:

C. W

2018.3.5

TITLE:

3.5 mm wire to Board housing

MATERILA:

PART NO:

H3500S12-XX-XX-X

SIZE:

A4

FINSH:

DWG NO:

H3500S12-XX-XX-X

REV:

A

UNIT

mm

SCALE

1=1

QUALITY

SYMBOLS

