

RoHS Compliant

1 2 3 4 5 6 7 8

REVISIONS		
REV.	DESCRIPTION	DATE

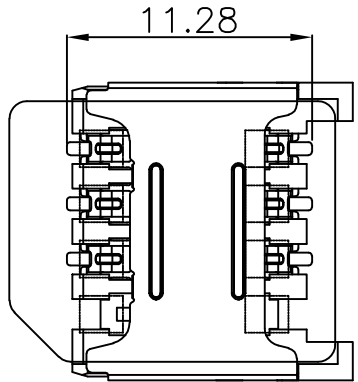
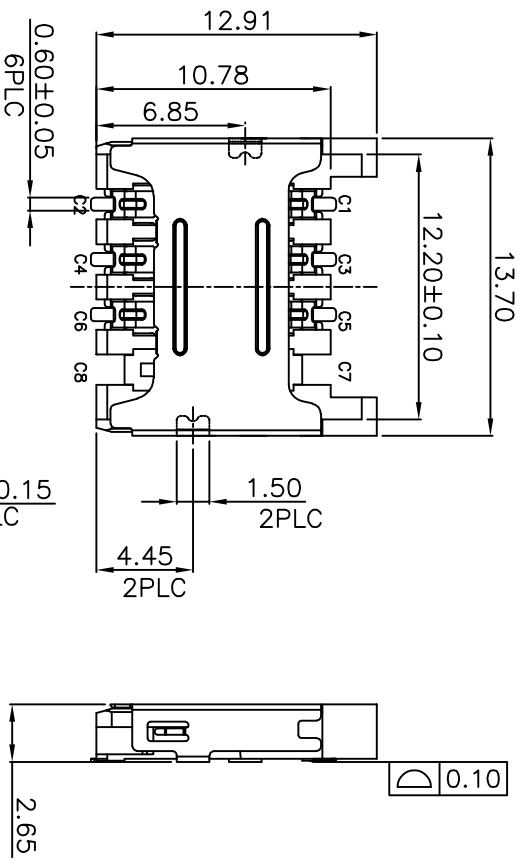

INSERT CARD

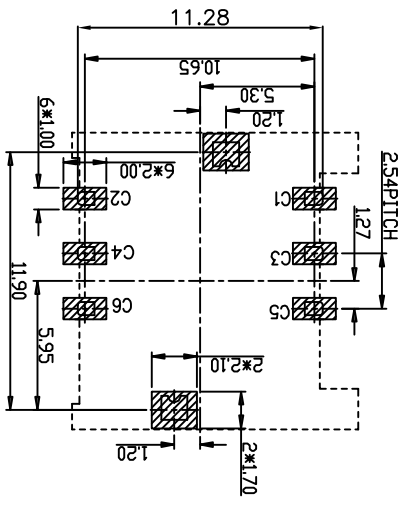

RECOMMENDED PCB LAYOUT(TOP VIEW)

GENERAL TOLERANCES:±0.05

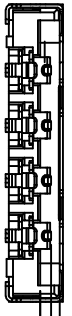

PIN NO.	DESCRIPTION
C1	VCC
C3	RST
C5	CLK
C2	GND
C4	VPP
C6	I/O
C8	

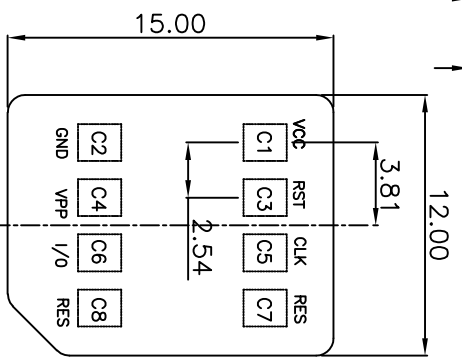

NOTES:  
 1) MATERIAL:  
 HOUSING: LCP UL 94V-0  
 CONTACT: COPPER ALLOY  
 SHELL: STAINLESS STEEL  
 2) FINISH :  
 CONTACT: GOLD FLASH PLATING ON CONTACT AREA;  
 GOLD FLASH PLATING ON SOLDER TAILS,  
 WITH ENTIRE CONTACT UNDERPLATED NICKEL  
 SHELL: NICKEL UNDERPLATED OVERALL,  
 GOLD FLASH PLATED ON SOLDER TAILS

PART NO.: MCSIM -06 X X 5 R - 017

- 06:06P CONTACT PLATED
- 1: GOLD FLASH
- 2: GOLD 3U"
- 3: GOLD 5U"
- 4: GOLD 10U"
- 5: GOLD 15U"
- 6: GOLD 30U"
- PACKAGE R: TAPE REEL
- HOUSING COLOR
- 2: WHITE
- 5: BLACK
- 9: NATURE
- HOUSING MATERIAL
- A: LCP B: PBT
- C: PA9T D: PA6T
- E: PA46 F: PA66

**Bestcreate Technology Limited**

TOLERANCES UNLESS OTHERWISE SPECIFIED:

X	±	0.25	X'	±	0.15
.XX	±	0.15	.XX'	±	0.10

DESIGN: 1.1 DATE: 2017.3.1

CHECKED: X DATE: 2017.3.1

APPROVED: C.W DATE: 2017.3.1

TITLE: MICRO SIM 2.65H 6PIN CARD CONN.

MATERIAL: MCSIM-06XX5R-017

FINISH: DMC NO: MCSIM-06XX5R-017

REV.	UNIT	SCALE	QUALITY SYMBOLS					
A	mm	1=1						

1 2 3 4 5 6 7 8

REVISIONS			
REV.	DESCRIPTION	DATE	DESIGN

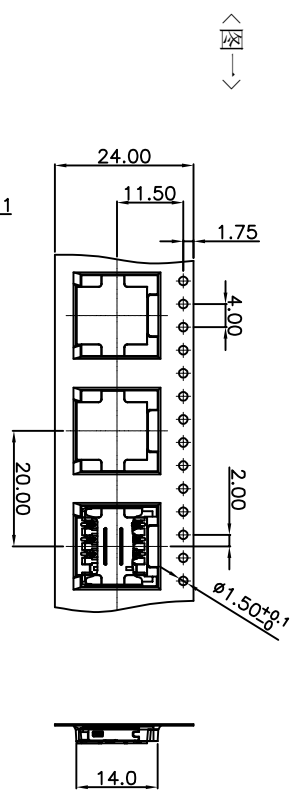

〈图一〉

〈表一〉 包装数量

PCS/卷	卷/箱	PCS/箱
1000	10	10000

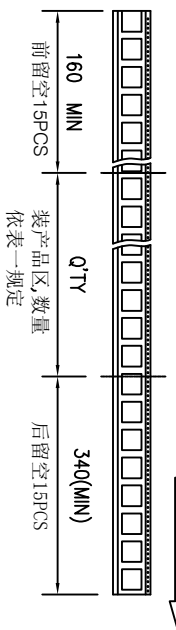

〈图二〉

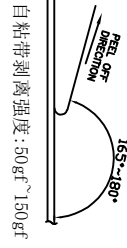
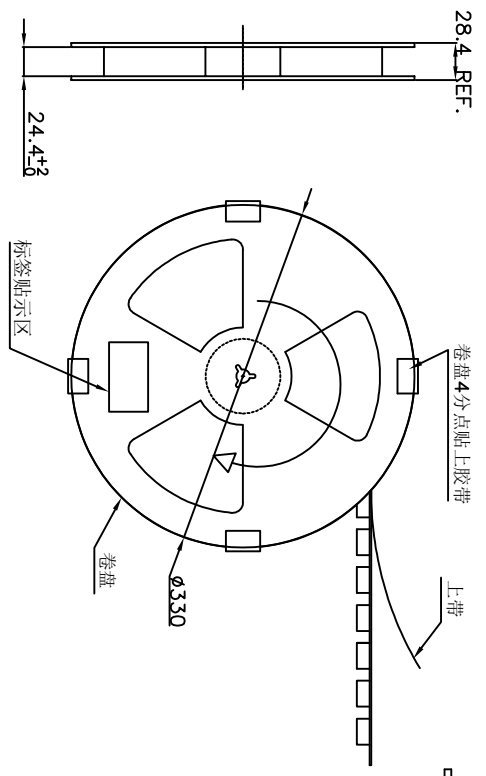

NOTE:

1. 依〈图一〉示放置产品于下表中, 每次放置1PCS产品.
2. 包装机包好后, 在REEL的个等分点贴上胶带, 以防止REEL张开, 每REEL贴1PCS标签, 如〈图二〉所示
3. 包装数量见如〈表一〉所示
4. 包装成箱见如〈图三〉所示
5. 封箱: 在封好的纸箱上按客户要求写上料号, 数量等

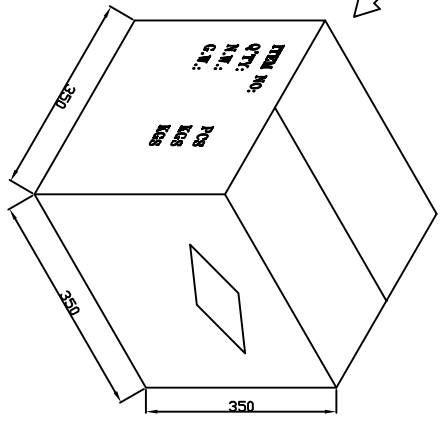
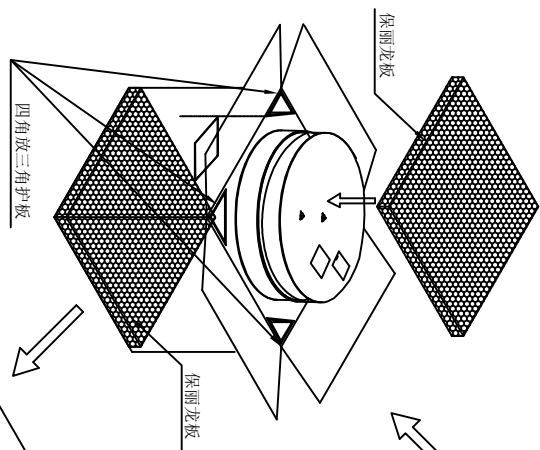

〈图三〉

# Bestcreate Technology Limited

TOLERANCES UNLESS OTHERWISE SPECIFIED:

尺寸	公差	尺寸	公差	尺寸	公差
X	± 0.35	X'	± 0.25	S'	± 0.15
XX	± 0.25	X''	± 0.15	T'	± 0.10
XXX	± 0.15	XX'	± 0.10		

DESIGN: DATE: 2017. 3. 1

CHECKED: DATE: 2017. 3. 1

C.W APPROVED: DATE: 2017. 3. 1

TITLE: MICRO SIM 2.65H 6PIN

CARD CONN. 包装图

MATERIA: PART NO: MCSIM-06XX5R-017

FINSH: DWG NO: MCSIM-06XX5R-017

SHEET: 2 OF 2