

RoHS Compliant

REVISIONS			
REV.	DESCRIPTION	DATE	DESIGN

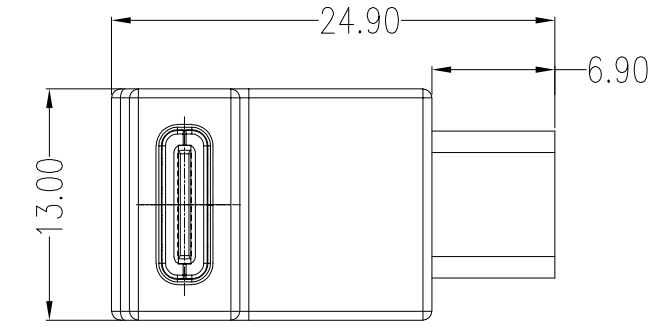

NOTE:
1. ELECTRICAL CHARACTERISTICS;
 2.1 CONTACT RESISTANCE: 80mΩ Max
 2.2 CONTACT CURRENT RATING: 1.5 A
 2.3 DIELECTRIC WITHSTANDING VOLTAGE: 100 V R.M.S.
 2.4 INSULATION RESISTANCE 100 MEGOHMS Min
 2.5 OPERATING TEMPERATURE: -25° C ~ 75° C
2 MECHANICAL CHARACTERISTICS:
 2.1 MATING FORCE: USB CM 5^{20N} & MICRO USB 35N Max.
 2.2 UNMATED FORCE: USB CM 8^{20N} & MICRO USB 10N Min.
3. PLATING
 3.1 TERMINAL CONTACT: (SEE TAB) GOLD PLATING ALL OVER 50u²MIN NICKEL
 3.2 SHELL: 50u²MIN NICKEL ALL OVER
 4. Molding No. AP-TYPEC-W001

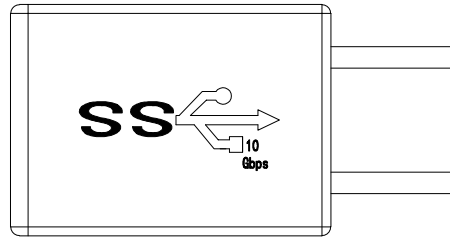
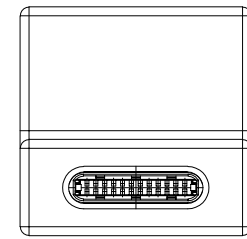
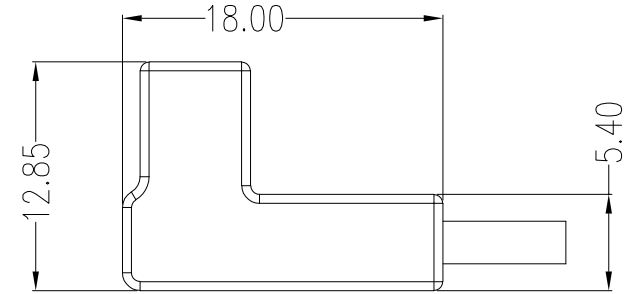
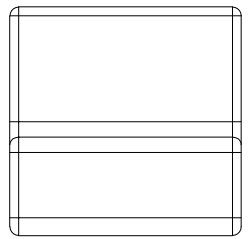

3	TYPE CM		TYPE C M NI	1PCS
2	TYPE CF		TYPE C F NI	0.005KG
1	PCBA		TYPE CM TO CF, NICKEL PLATED	1PCS
Item	Name	Part Number	Description	Q'TY

Bestcreate Technology Limited

TOLERANCES UNLESS OTHERWISE SPECIFIED:

X.	± 0.50	X.'	± 5'
.X	± 0.30	.X'	± 2'
.XX	± 0.10	.XX'	± 1'

DESIGN:	DATE:
I.L	2017.3.1
CHECKED:	DATE:
C.W	2017.3.1
APPROVED:	DATE:
C.W	2017.3.1

TITLE:		
USB3.1 CM TO USB3.1 CF ADAPTER		
MATERILA:	PART NO:	SIZE:
	AD31CMCF-060	A4
FINSH:	DWG NO:	
	AD31CMCF-060	

REV:	UNIT	SCALE	QUALITY SYMBOL
A		mm 1=1	

Website: www.bsc-elec.com
 Email: bestcreate@bsc-elec.com