

RoHS Compliant

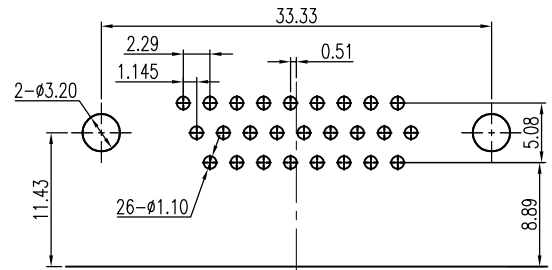
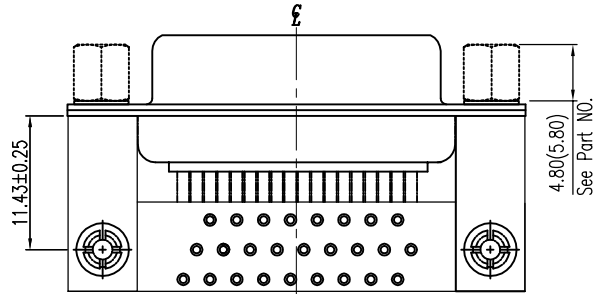
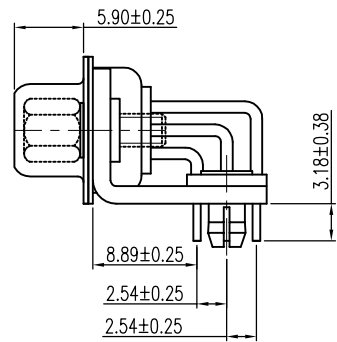
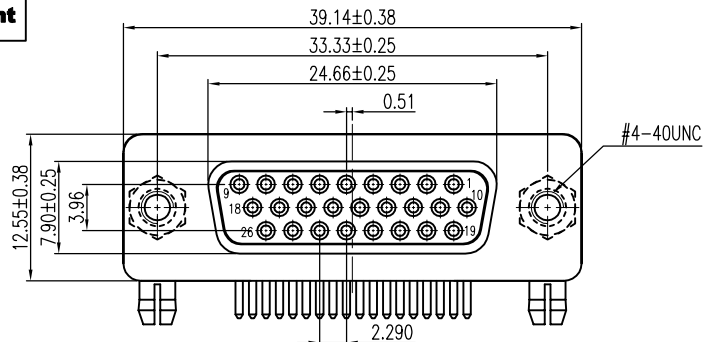

RECOMMENDED P.C.B. LAYOUT

REVISIONS			
REV.	DESCRIPTION	DATE	DESIGN

- NOTE:
- MATERIALS AND FINISHED
 INSULATOR : PBT+30% GF UL 94V-0,
 SHELL : STEEL, NI FINISHED
 CONTACT MATERIAL : BRASS, SELEVITE GOLD FINISHED
 RIVETED INSERT: BRASS MATERIAL ,NI FINISHED
 WITH #4-40 THREADED ASSEMBLED
 - ELECTRICAL CHARACTERISTICS
 CURRENT RATING : 3.0 AMP DC
 VOLTAGE RATING: 250 V DC
 CONTACT RESISTANCE :30 MILLIOHMS MAX.
 DIELECTRIC WITHSTANDING VOLTAGE : 1000 V AC MIN.
 INSULATION RESISTANCE : 1000 MEGAOHMS MIN.
 - ENVIRONMENTAL
 OPERATING TEMPERATURE: -55°C ~ +85°C
 STORAGE TEMPERATURE:-55°C ~ +105°C
 - HOW TO ORDER:

HRF241-26GX1P-XX710

F: Female	0: RoHS
2: Vehicle processing	1: Dip=3.18
4: HDR(8.89)	7: "L"Bracket W/Harpoon+Board
	3: "L"Bracket W/Hole(10.4)
	0: W/O Bracket
15: H15PIN	44: H15PIN
26: H15PIN	62: H15PIN
G: Full Gold	K: 5.8*12.8 Hexagonal Screw(iron)
	J: 5.8*12.8 Hexagonal Screw(copper)
	6: 4.8*11.8 Hexagonal Screw(iron)
	5: 4.8*11.8 Hexagonal Screw(copper)
	0: W/O Screw
1:G/F	5: 5u"
2:2u"	6: 10u"
3:3u"	7: 15u"
	8: 30u"
1. Front Ni Back Tin	A: No screw type
	B: Ass'y screw type
	C: Attach screw type
	D: Fork Lock
	P: PBT L: LCP
	B: Black W: White

Bestcreate Technology Limited

REV: A	UNIT mm	SCALE 1=1	QUALITY SYMBOLS
--------	---------	-----------	-----------------

TOLERANCES UNLESS OTHERWISE SPECIFIED:			
.X	± 0.35	X'	± 3'
.XX	± 0.25	.X'	± 2'
.XXX	± 0.15	.XX'	± 1'
Website:www.bsc-elec.com			
Email:bestcreate@bsc-elec.com			

DESIGN: I.L	DATE: 2017.3.1
CHECKED: C.W	DATE: 2017.3.1
APPROVED: C.W	DATE: 2017.3.1

TITLE: HDR 8.89-26P FEMALE CONNECTOR		
MATERIAL: FINISH:	PART NO: HRF241-26GX1P-XX710	SIZE: A4
DWG NO: HRF241-26GX1P-XX710		