

由 Autodesk 教育版产品制作

由 Autodesk 教育版产品制作

RoHS Compliant

| REVISIONS | | | |
|-----------|-------------|------|--------|
| REV. | DESCRIPTION | DATE | DESIGN |
| | | | |

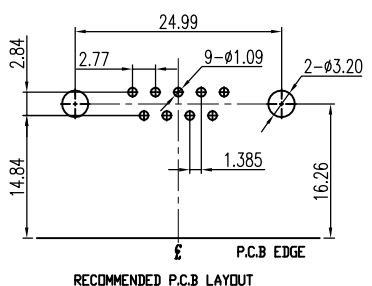
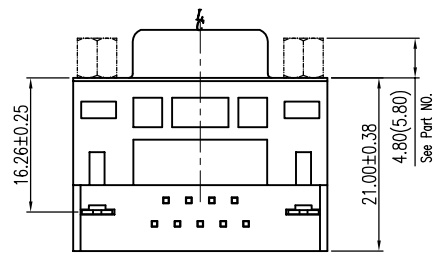
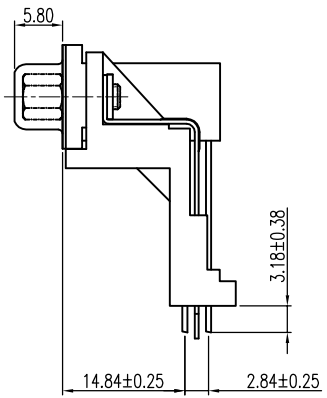
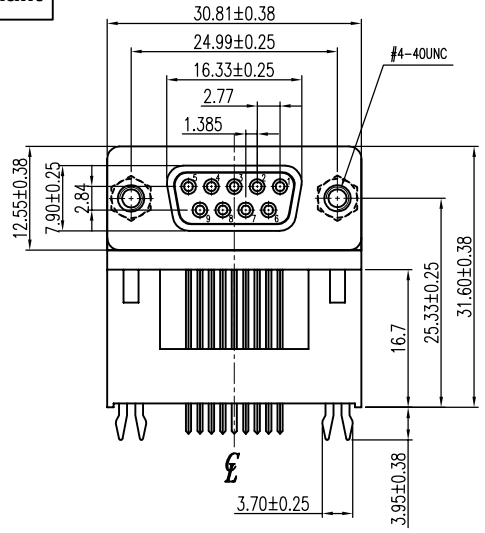

NOTE:
 1.MATERIALS AND FINISHED
 INSULATOR : PBT GF30% UL 94V-0, BLACK,
 SHELL : STEEL, NI FINISHED
 CONTACT MATERIAL : BRASS, SELEVITE GOLD FINISHED
 RIVETED INSERT: BRASS MATERIAL ,TIN FINISHED
 WITH #4-40 THREADED ASSEMBLED
 2.ELECTRICAL CHARACTERISTICS
 CURRENT RATING : 3 AMP
 VOLTAGE RATING: 300 V DC
 CONTACT RESISTANCE :20 MILLIOHMS MAX.
 DIELECTRIC WITHSTANDING VOLTAGE : 1000 V AC MIN.
 INSULATION RESISTANCE : 1000 MEGAOHMS MIN.
 3.ENVIRONMENTAL
 OPERATING TEMPERATURE: -55°C ~ +85°C
 STORAGE TEMPERATURE:-55°C ~ +105°C
 4.HOW TO ORDER:

DRF181-XXXX5XP-XX210

| | |
|--|--|
| F: Female | 0: RoHs |
| 1: Stamping forming | 1:steel harpoon 2:copper harpoon |
| 6: DR(10.2) | 5: 4.8*11.8copper screws 6: 4.8*11.8steel screws J: 5.8*12.8copper screws K: 5.8*12.8steel screws |
| 09: 9PIN 25: 25PIN 15: 15PIN 37: 37PIN | A:No_screw type B:Ass'y screw type C:Attach screw type D:Fork Lock |
| G: Full Gold S: Selevite Gold Bright TIN | P: PBT A: PA9T |
| 1:1u" 5: 5u" 2:2u" 6: 10u" 3:3u" 7: 15u" 8: 30u" | B: Black G: Green |
| 4. FULL Gold 5. FULL NI | |

Bestcreate Technology Limited

| | | | |
|--|--------|------|------|
| TOLERANCES UNLESS OTHERWISE SPECIFIED: | | | |
| .X | ± 0.38 | X.* | ± 3" |
| .XX | ± 0.25 | .X* | ± 2" |
| .XXX | ± 0.15 | .XX* | ± 1" |
| Website:www.bsc-elec.com | | | |
| Email:bestcreate@bsc-elec.com | | | |

| | |
|-----------|----------|
| DESIGN: | DATE: |
| I.L | 2017.3.1 |
| CHECKED: | DATE: |
| C.W | 2017.3.1 |
| APPROVED: | DATE: |
| C.W | 2017.3.1 |

| | | |
|----------------------------------|----------------------------------|-------------|
| TITLE: DR 9P FEMALE CONNECTOR | | |
| MATERILA: | PART NO: DRF181.XXXX5XP.XX210 | SIZE: A4 |
| FINSH: | DWG NO: DRF181.XXXX5XP.XX210 | |

| | | | |
|--------|---------|-----------|-----------------|
| REV: A | UNIT mm | SCALE 1=1 | QUALITY SYMBOLS |
|--------|---------|-----------|-----------------|

由 Autodesk 教育版产品制作