

RoHS Compliant

| REVISIONS | | | |
|-----------|-------------|------|--------|
| REV. | DESCRIPTION | DATE | DESIGN |
| | | | |

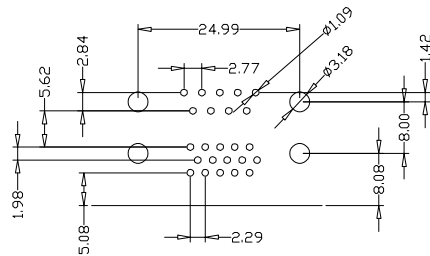
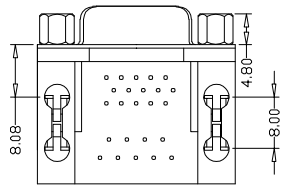
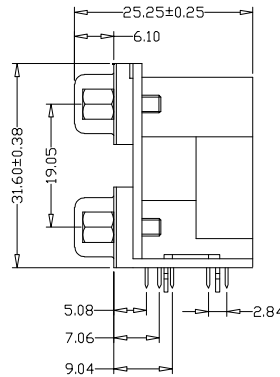
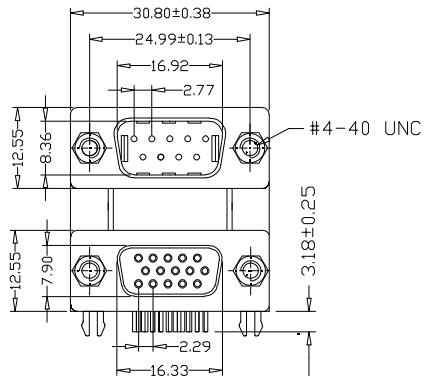

P.C.B LAYOUT

MATERIALS AND FINISH

SHELL : STEEL MATERIAL, NICKEL FINISHED
 INSULATOR : PBT THERMOPLASTIC, 30% GLASS FILLED, UL 94V-0 RATED, BLACK COLOR
 CONTACT MATERIAL : BRASS
 CONTACT FINISH : SELECTIVE GOLD FINISHED
 GROUNDING BRACKET : ZINC ALLOY, ZINC PLATED
 JACK SCREWS : BRASS MATERIAL , NICKEL FINISH WITH #4-40 THREADED JACK SCREWS

ELECTRICAL CHARACTERISTICS

CONTACT CURRENT RATING : 5.0 AMPS
 CONTACT RESISTANCE : 30 MILLIOHMS MAX.
 DIELECTRIC WITHSTANDING VOLTAGE : 1000 V AC MIN.
 INSULATION RESISTANCE : 5000 MEGAOHMS MIN.
 TEMPERATURE RATING : -55°C ~ +105°C

HOW TO ORDER:

DL201X-19SX511-BX320

Male+Male

DR+HDR

2: DimX/Y=19.05/31.60

1: DimX/Y=15.88/28.43

18: 09Pin+15PIN

S:Selevite Gold Bright TIN

M:Selevite Gold Matte TIN

1:G/F 5: 5u"

2:2u" 6: 10u"

3:3u" 7: 15u" 9: 1u"

5. Full Ni(Shell)

0: RoHs

2: Lower-DR 8.08

3: Quad Arrowhead Boardlock (8.08x8.0)

K: 5.8*12.8 Hexagonal Screw(iron)

J: 5.8*12.8 Hexagonal Screw(copper)

6: 4.8*11.8 Hexagonal Screw(iron)

5: 4.8*11.8 Hexagonal Screw(copper)

0: W/O Screw

C: Attach screw type

B: Assy screw type

A: No screw type

1: PBT+PBT

1: All Black

Bestcreate Technology Limited

TOLERANCES UNLESS OTHERWISE SPECIFIED:

| | | | |
|------|--------|------|------|
| .X | ± 0.35 | X.* | ± 3' |
| .XX | ± 0.25 | .X' | ± 2' |
| .XXX | ± 0.15 | .XX' | ± 1' |

Website:www.bsc-elec.com
 Email:bestcreate@bsc-elec.com

DESIGN: I. L DATE: 2017. 3. 1

CHECKED: C. W DATE: 2017. 3. 1

APPROVED: C. W DATE: 2017. 3. 1

TITLE: D-SUB 09P MALE TO HDR 15P FEMALE 19.05MM

| | | |
|-----------|-------------------------------|----------|
| MATERILA: | PART NO: DL201X-19SX511-XX320 | SIZE: A4 |
| FINSH: | DWG NO: DL201X-19SX511-XX320 | |

| | | | |
|--------|---------|-----------|-----------------|
| REV: A | UNIT mm | SCALE 1=1 | QUALITY SYMBOLS |
|--------|---------|-----------|-----------------|