

RoHS Compliant

REVISIONS			
REV.	DESCRIPTION	DATE	DESIGN

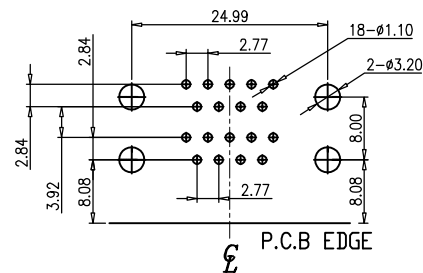
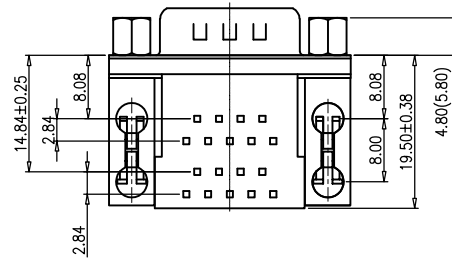
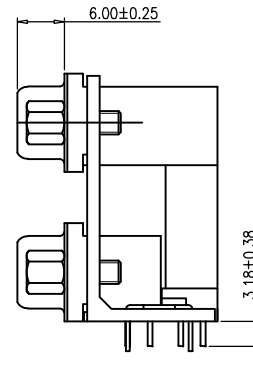
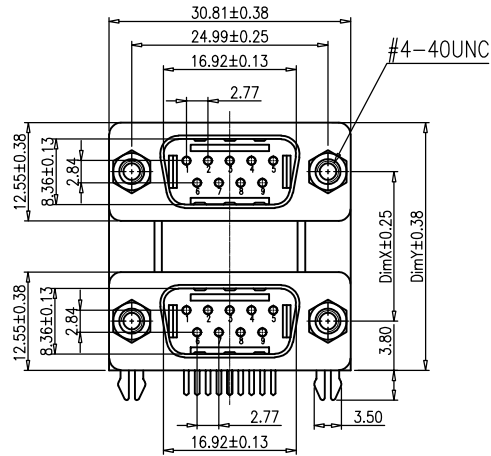

RECOMMENDED P.C.B LAYOUT

NOTE:

- MATERIALS**  
 INSULATOR : PBT+30% GF UL 94V-0, Black.  
 CONTACT : COPPER ALLOY.  
 SHELL : STEEL.  
 BOARDLOCK : SPCC.  
 BRACKET : ZINC ALLOY  
 SCREW : STEEL OR COPPER ALLOY
- FINISHED**  
 CONTACT : GOLD(SEE P.N.)PLATED AT CONTACT AREA.  
 TIN PLATED ON SODERING TAIL.  
 NICKL UNDERPLATING OVER ALL.  
 SHELL : NICKL PLATED.  
 BOARDLOCKS: TIN PLATED, NICKL UNDERPLATING OVER ALL.  
 BRACKET : NICKL MIN PLATED.  
 SCREW : NICKL PLATED.
- ELECTRICAL CHARACTERISTICS**  
 CURRENT RATING : 1 AMP DC  
 VOLTAGE RATING: 250 V DC  
 CONTACT RESISTANCE :30 MILLIOHMS MAX.  
 DIELECTRIC WITHSTANDING VOLTAGE : 1000 V AC MIN.  
 INSULATION RESISTANCE : 1000 MEGAOHMS MIN.
- ENVIRONMENTAL**  
 OPERATING TEMPERATURE: -55°C ~ +85°C  
 STORAGE TEMPERATURE:-55°C ~ +105°C
- HOW TO ORDER:**

**DL101X-18SX511-BX320**

Male+Male

DR+DR

2: DimX/Y=19.05/31.60

1: DimX/Y=15.88/28.43

18: 09Pin+09PIN

S:Selevite Gold Bright TIN

M:Selevite Gold Matte TIN

1:G/F 5: 5u"

2:2u" 6: 10u"

3:3u" 7: 15u" 9: 1u"

5. Full Ni(Shell)

0: RoHs

2: Lower-DR 8.08

3: Quad Arrowhead Boardlock (8.08x8.0)

- K: 5.8\*12.8 Hexagonal Screw(iron)
- J: 5.8\*12.8 Hexagonal Screw(copper)
- 6: 4.8\*11.8 Hexagonal Screw(iron)
- 5: 4.8\*11.8 Hexagonal Screw(copper)
- 0: W/O Screw

- C: Attqch screw type
- B: Ass'y screw type
- A: No screw type

1: PBT+PBT

1: All Black

**Bestcreate Technology Limited**

TOLERANCES UNLESS OTHERWISE SPECIFIED:

.X	± 0.35	X.*	± 2'
.XX	± 0.25	.X*	± 1'
.XXX	± 0.15	.XX*	± 0.5'

Website:www.bsc-elec.com

Email:bestcreate@bsc-elec.com

DESIGN:

DATE:

I. L

2017. 3. 1

CHECKED:

DATE:

C. W

2017. 3. 1

APPROVED:

DATE:

C. W

2017. 3. 1

TITLE:

D-SUB 9P MALE TO D-SUB 9P MALE 8.08MM(8.08x8.0)

MATERILA:

PART NO:

DL101X-18SX511-BX320

SIZE:

A4

FINSH:

DWG NO:

DL101X-18SX511-BX320

REV:

A

UNIT

mm

SCALE

1=1

QUALITY

SYMBOLS

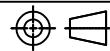

1

2

3

4

5

6

7

8