

RoHS Compliant

REVISIONS			
REV.	DESCRIPTION	DATE	DESIGN

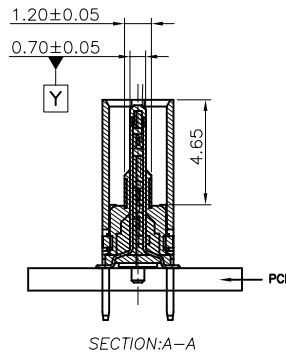
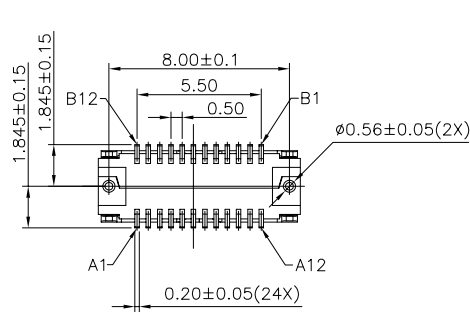
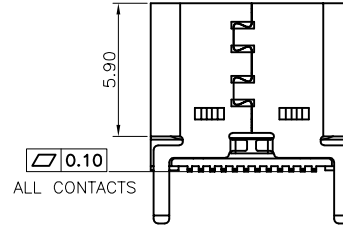
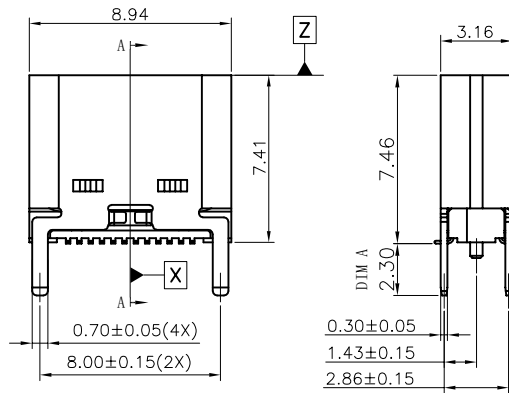
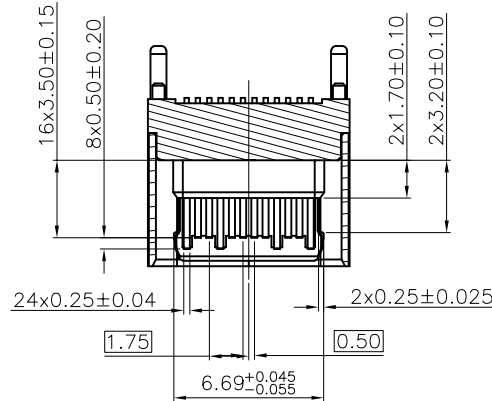
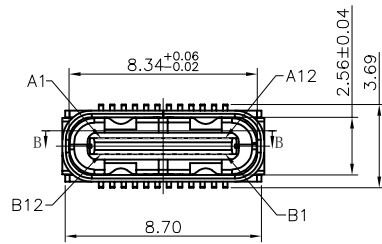

NOTE:
 1.ELECTRICAL PERFORMANCE,
 1-1.CURRENT RATING:5 AMPS. FOR TOTAL VBUS/GND PINS;
 1.25AMPS FOR CC PIN,0.25 AMPS. FOR ALL OTHER CONTACT.
 1-2. VOLTAGE RATING:5 V DC/AC (RMS. max)
 1-3. LLCR:.
 VBUS & GND PINS AND OTHER PINS: 40mΩ/PIN MAX.
 SHIELD:50mΩ/MAX.
 LLCR MAX. CHANGE OF ALL PINS: 10mΩ.
 1-3.INSULATION RESISTANCE: 100MΩ MIN
 1-4.DIELECTRIC WITHSTAND VOLTAGE,AC 100V FOR 1 MINUTE.
 2.MECHANICAL PERFORMANCE,
 2-1.INSERTION FORCE: 5~20N.
 2-2.REMOVAL FORCE: 8~20N.
 2-3.DURABILITY: 10000 CYCLES.
 3.ENVIRONMENTAL PERFORMANCE:
 OPERATING TEMPERATURE: -25°C~+85°C.
 4.IR REFLOW:
 THE PEAK TEMPERATURE ON THE BOARD SHALL BE MAINTAINED FOR 10 SECONDS AT 260°C.

PART NO. INFORMATION

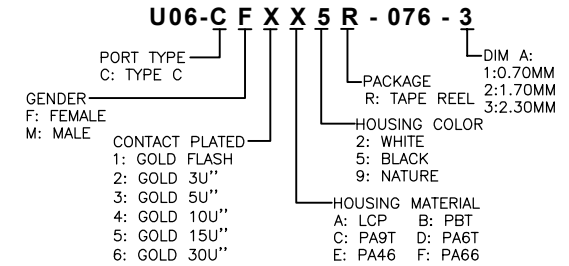

TABLE:

NO	PART	Q'TY	Material
1	SHELL	1	Stainless Steel SUS304 T=0.30mm, NI 30u'' MIN PLATED
2	EMI Plate	1	Stainless Steel SUS301 T=0.10mm,NI 30u'' MIN PLATED
3	Mid Plate	1	Stainless Steel SUS301 T=0.15mm, Matte Tin plated 50u''min on solder area;Nickel 50u''min underplating over all.
4	CONTACT	24	COPPER STEEL C18400, Au3u''plated on contact area GF plated 50u''min on solder area;Nickel 50u''min underplating over all.
5	HOUSING	1	PA9T BLACK UL94 V-0

Bestcreate Technology Limited

TOLERANCES UNLESS OTHERWISE SPECIFIED:

.X	± 0.30	.X'	± 5'
.XX	± 0.29	.X''	± 2'
.XXX	± 0.10	.X'''	± 1'

Website:www.bsc-elec.com
 Email:bestcreate@bsc-elec.com

DESIGN: I. L DATE:

CHECKED: C. W DATE:

APPROVED: C. W DATE:

TITLE: USB 3.1 C FEMALE 24P CONNECTOR VERTICAL H=7.46MM SMT TYPE

MATERILA: PART NO: U06-CFXX5R-076-3 SIZE: A4

FINSH: DWG NO: U06-CFXX5R-076-3 1 OF 2

REV: A UNIT mm SCALE 1=1 QUALITY SYMBOLS

RoHS Compliant

REVISIONS			
REV.	DESCRIPTION	DATE	DESIGN

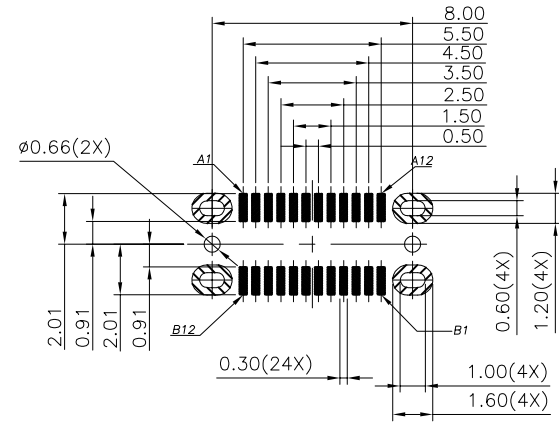
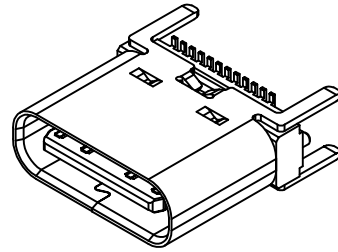
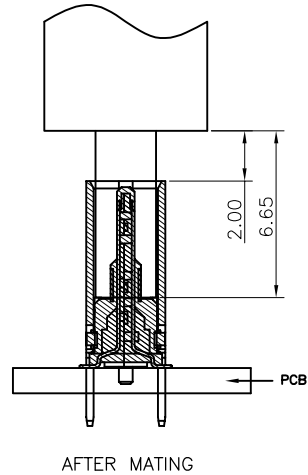

RECOMMENDED PCB LAYOUT(TOP VIEW)
 THICKNESS 1.0±0.10MM;DEFAULT TOLERANCE:±0.05

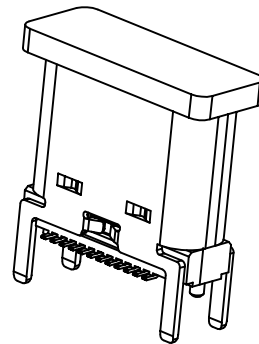
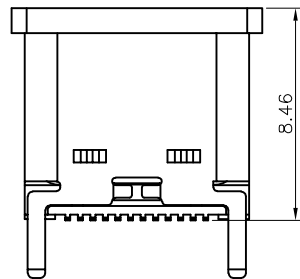
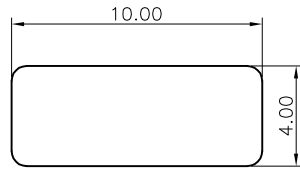

PIN DEFINITION:

PIN No.	A1	A2	A3	A4	A5	A6	A7	A8	A9	A10	A11	A12
	GND	TX1+	TX1-	VBus	CC1	D+	D-	SBU1	VBus	RX2-	RX2+	GND
	GND	RX1+	RX1-	VBus	SBU2	D-	D+	CC2	VBus	TX2-	TX2+	GND
PIN No.	B12	B11	B10	B9	B8	B7	B6	B5	B4	B3	B2	B1

Bestcreate Technology Limited

TOLERANCES UNLESS OTHERWISE SPECIFIED:

X.	±	0.30	X.'	±	5'
.X	±	0.25	.X'	±	2'
.XX	±	0.10	.XX'	±	1'

Website:www.bsc-elec.com
 Email:bestcreate@bsc-elec.com

DESIGN:
I. L

DATE:

CHECKED:
C. W

DATE:

APPROVED:
C. W

DATE:

TITLE:

USB 3.1 C FEMALE 24P CONNECTOR VERTICAL H=7.46MM
 SMT TYPE

MATERILA:

PART NO:
U06-CFXX5R-076-3

SIZE:
A4

FINSH:

DWG NO:
U06-CFXX5R-076-3

2 OF 2

REV:
A

UNIT
mm

SCALE
1=1

QUALITY SYMBOLS

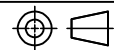

1

2

3

4

5

6

7

8