

RoHS Compliant

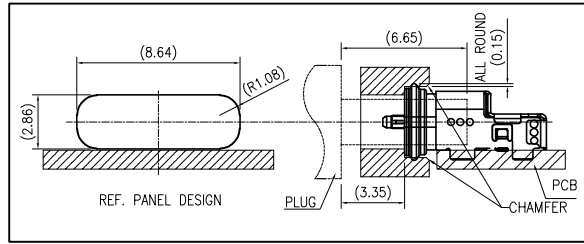

REVISIONS			
REV.	DESCRIPTION	DATE	DESIGN

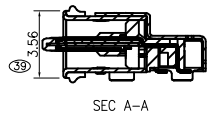
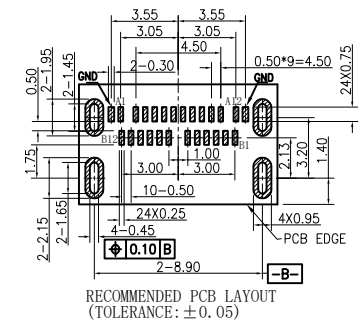

- NOIES:
- ELECTRICAL CHARACTERISTICS:
 - CONTACT CURRENT RATING: 5.0A FOR VBUS PIN AND ITS CORRESPONDING GND PIN.
 - CONTACT RESISTANCE: 30 MILLIOHMS MAX FOR VBUS AND GND CONTACTS. 40 MILLIOHMS MAX FOR ALL OTHER CONTACTS.
 - DIELECTRIC WITHSTANDING VOLTAGE: 100 VRMS AC MIN.
 - INSULATION RESISTANCE: 100 MEGOHMS MIN.
 - MECHANICAL CHARACTERISTICS:
 - CONNECTOR INSERTION FORCE: 5~20N. AT A MAXIMUM RATE OF 12.5MM PER MINUTE.
 - CONNECTOR EXTRACTION FORCE: 8~20N AT A MAXIMUM RATE OF 12.5MM PER MINUTE. 6~20N AFTER DURABILITY TEST.
 - DURABILITY: 10000 CYCLES.
 - OPERATING TEMPERATURE: -55°C TO +85°C
 - SALT SPRAY: 48HOURS.
 - DIMENSIONS ARE IN MILLIMETERS, BRACKETED DIMENSIONS ARE INCHES EQUIVALENTS.
 - RECOMMENDED PROCESS: IR REFLOW 260°C, 3~5SECONDS.
 - THE CONNECTOR IS ROHS COMPLIANT AND HALOGEN FREE COMPLIAN.
 - Mark "⊗" REFERS TO FAI INSPECTION DIMENSION
 - Mark "▲" IS THE KEY INSPECTION DIMENSION OF IPQC
 - Mark "▽" IS CPK SIZE

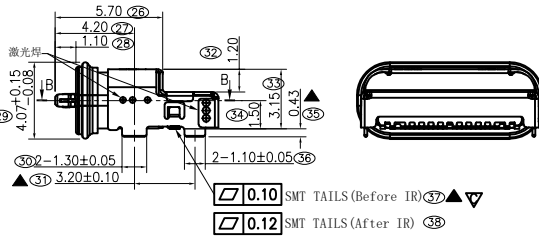
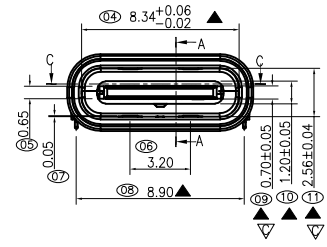
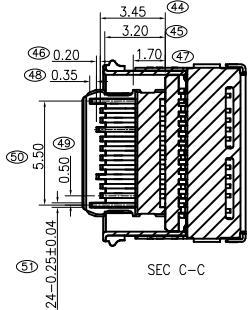
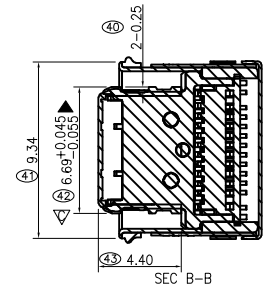
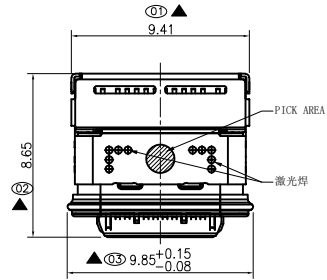

□ 0.10 SMT TAILS (Before IR) 37 ▲ ▲ ▲
 □ 0.12 SMT TAILS (After IR) 38

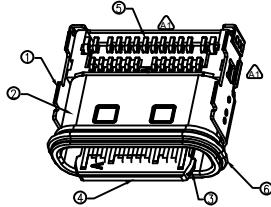
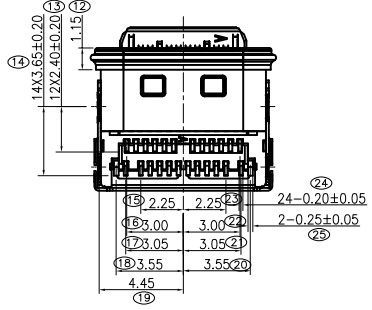

ITEM	PART NAME	Q'TY	Material&Plating
1	SUB-SHELL	1	SUS304 t=0.15, Ni PLATED 30u"
2	MAIN-SHELL	1	SUS316L t=0.20 CLEANING
3	LATCH	1	SUS301 t=0.15, Ni PLATED 30u"
4	HOUSING	1	PA9T+30%GF, HF BLACK
5	CONTACT	24	C7025 t=0.12, Ni 50-150u" UNDER PLATED OVER. 30u"Au PLATED ON THE CONTACT AREA, 3-8u"Au PLATED ON THE SOLDER TAILS.
6	Waterproof glue	1	Silicone black(assemble); Pull force 50g

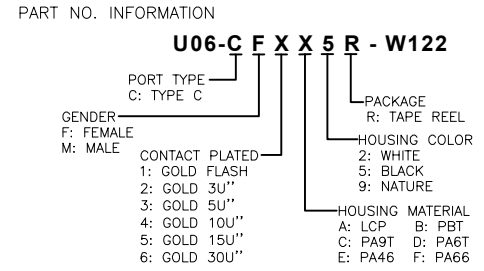

Bestcreate Technology Limited

TOLERANCES UNLESS OTHERWISE SPECIFIED:		DESIGN:	DATE:
X.	± 0.50	I. L	
.X	± 0.30	CHECKED:	DATE:
.XX	± 0.10	C. W	
Website: www.bsc-elec.com		APPROVED:	DATE:
Email: bestcreate@bsc-elec.com		C. W	

TITLE:		
IPX8 WATERPROOF 24P USB C FEMALE CONNECTOR SMT TYPE		
MATERILA:	PART NO:	SIZE:
	U06-CFX5R-W122	A4
FINSH:	DWG NO:	
	U06-CFX5R-W122	1 OF 1

REV: A	UNIT mm	SCALE 1=1	QUALITY SYMBOLS
--------	---------	-----------	-----------------