

RoHS Compliant

REVISIONS			
REV.	DESCRIPTION	DATE	DESIGN

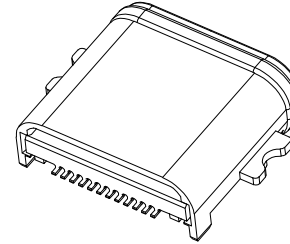
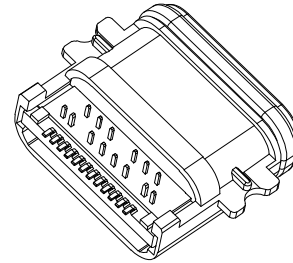
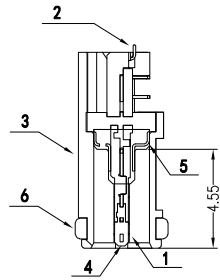
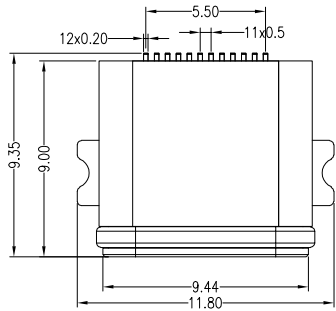

SPECIFICATION:

- 1.ELECTRICAL:  
 1-1:CURRENT RATING:  
 VBUS AND GND CONTACTS RATED AT 1.25A  
 PARALLELED FOR A TOTAL OF 5A;  
 1-2:INITIAL CONTACT RESISTANCE :40 MEGOHMS  
 1-3:DIELECTRIC WITHSTANDING VOLTAGE:  
 100V AC MIN;  
 2:MECHANICAL CHARACTERISTICS:  
 2-1:MATING FORCE:5~20N  
 2-2:UNMATING FORCE:8~20N(INITIAL),  
 6~20N(AFTER 10000 CYCLES)  
 2-3:FREQUENCE: 200±50 CYCLES /HOUR,10000 CYCLES  
 2-4:OPERATING TEMPERATURE ;-40'~80'.  
 3: WATERPROOF: IP-X7.

TABLE B

A1	GND	B12	GND
A2	SSTXP1	B11	SSRXP1
A3	SSTXN1	B10	SSRXN1
A4	VBUS	B9	VBUS
A5	CC1	B8	SBU2
A6	DP1	B7	DN2
A7	DN1	B6	DP2
A8	SBU1	B5	CC2
A9	VBUS	B4	VBUS
A10	SSRXN2	B3	SSTXN2
A11	SSRXP2	B2	SSTXP2
A12	GND	B1	GND
PIN	SIGNAL NAME	PIN	SIGNAL NAME

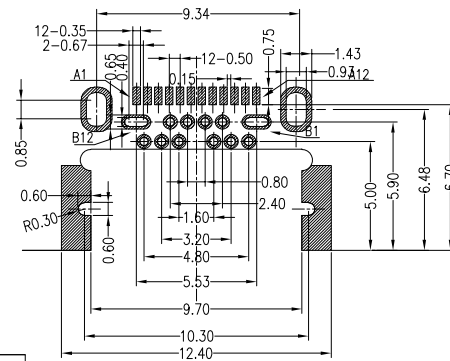
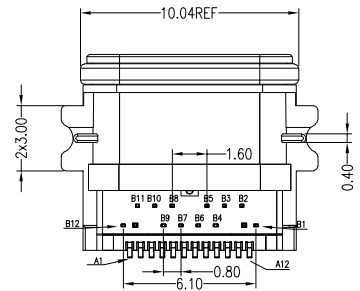
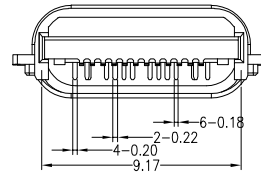
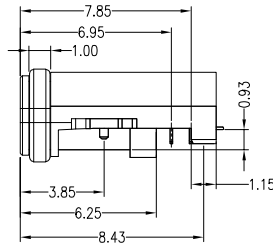
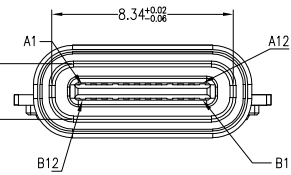

RECOMMEND PCB LAYOUT  
 TOL=±0.05

PART NO. INFORMATION

**U06-C F X X 5 R - W021**

- PORT TYPE  
 C: TYPE C
- GENDER  
 F: FEMALE  
 M: MALE
- CONTACT PLATED  
 1: GOLD FLASH  
 2: GOLD 3U''  
 3: GOLD 5U''  
 4: GOLD 10U''  
 5: GOLD 15U''  
 6: GOLD 30U''
- PACKAGE  
 R: TAPE REEL
- HOUSING COLOR  
 2: WHITE  
 5: BLACK  
 9: NATURE
- HOUSING MATERIAL  
 A: LCP B: PBT  
 C: PA9T D: PA6T  
 E: PA46 F: PA66

TABLE A

NO.	DESCRIPTION	MATERIAL	FINISH PLANTED	QTY
6	RING	SILICON	---	1PCS
5	MID-PLANT	STAINLESS STEEL	---	1PCS
4	GND-PLANT	STAINLESS STEEL	NI/SN Plated	1PCS
3	SHELL	ZN-ALLOY	---	1PCS
2	CONTACT	COPPER ALLOY	Au/Ni Plated	2SET
1	HOUSING	HIGH TEMPERATURE PLASTIC	BLACK	1PCS

**Bestcreate Technology Limited**

TOLERANCES UNLESS OTHERWISE SPECIFIED:

X.	±	0.50	X.'	±	10'
.X	±	0.30	.X'	±	8'
.XX	±	0.20	.XX'	±	5'

Website:www.bsc-elec.com

Email:bestcreate@bsc-elec.com

DESIGN:

I.L

DATE:

CHECKED:

C.W

DATE:

APPROVED:

C.W

DATE:

TITLE:

**MID MOUNT USB 3.1 TYPE C FEMALE CONNECTOR**

MATERILA:

FINSH:

PART NO:

DWG NO:

U06-CFX5R-W021

U06-CFX5R-W021

SIZE:

A4

REV: A

UNIT mm

SCALE 1=1

QUALITY SYMBOLS

