

RoHS Compliant

REVISIONS			
REV.	DESCRIPTION	DATE	DESIGN

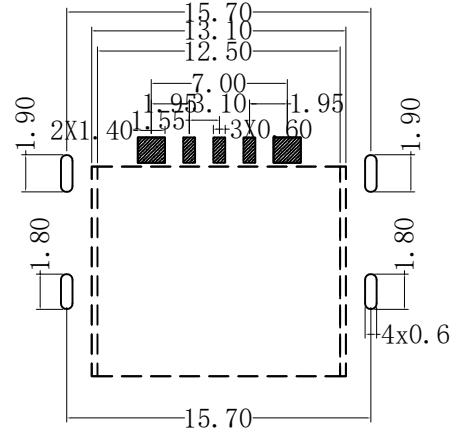
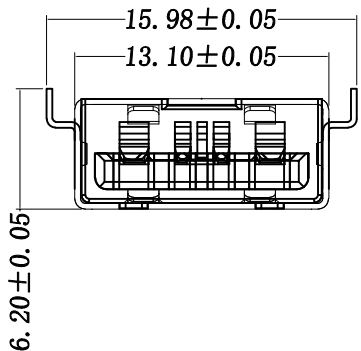
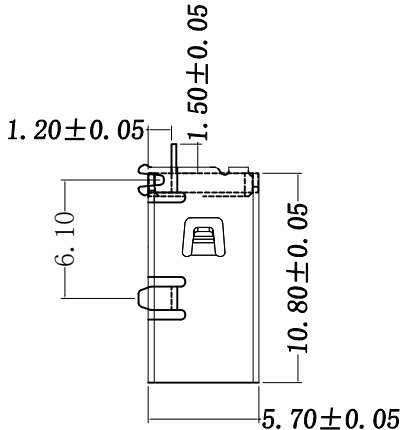
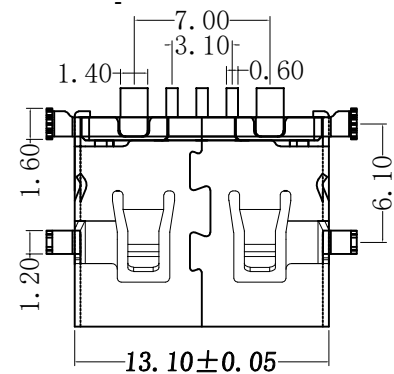
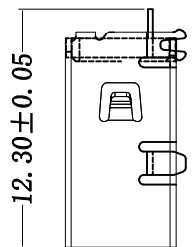

P C B

规格说明: Specifications:

电气特性: Electrical:

1. 额定电流: Current Rating
3A/contact terminal
2. 额定电压: Voltage Rating
30V DC
3. 接触电阻: Contact Resistance
30 milliohms MAX
4. 耐电压: Dielectric Withstanding Voltage:
500 V AC AT Sea Level
5. 绝缘电阻: Insulation Resistance:
1000MEGA ohms MIN

物理性能: Mechanical:

1. 插拔力: Connector Mate and Unmate Force
Mate force: 3.57kgf(MAX)
Unmate force: 1.02kgf(MIN)
2. 端子保持力: Terminal Retention
1.0kgf(MIN)

原材料: Material:

1. 塑胶: Housing:
High Temperature LCP green/blue/red
2. 端子: Contact: Copper Alloy C2680
3. 外壳: Shell: Copper Alloy C2680/SPCC

电镀: Finish:

1. 端子: Contact: Plated Gold in Mating Area;
Tin On Solder Tails

端子四周镀50U”(MIN)锡, 镀金区域镀100-200U”镀金1U”

2. 外壳: Shell:
铁壳四周镀80U”(MIN)锡 盐雾24H
Nickel Plating

PART NO. INFORMATION

U02-5AFXXXT-004-V1

- PIN NUMBER
5: 5PIN
- PORT TYPE
A: TYPE A
- GENDER
F: FEMALE
M: MALE
- CONTACT PLATED
1: GOLD FLASH 2: GOLD 3U”
3: GOLD 5U” 4: GOLD 10U”
5: GOLD 15U” 6: GOLD 30U”
- PACKAGE
T: TRAY R: TAPE&REEL
- HOUSING COLOR
1: ORANGE 2: BLUE
5: BLACK 9: GREEN
- HOUSING MATERIAL
A: LCP B: PBT
C: PA9T D: PA6T
E: PA46 F: PA66

Bestcreate Technology Limited

TOLERANCES UNLESS OTHERWISE SPECIFIED:			
.X	± 0.20	.X'	± 5'
.XX	± 0.10	.X'	± 2'
.XXX	± 0.02	.Xx'	± 1'

Website: www.bsc-elec.com
Email: bestcreate@bsc-elec.com

DESIGN:	DATE:
I. L	2017. 3. 1
CHECKED:	DATE:
C. W	2017. 3. 1
APPROVED:	DATE:
C. W	2017. 3. 1

TITLE: MID MOUNT 1.2MM 5P USB 2.0 A FEMALE CONNECTOR WITH LARGE CURRENT		
MATERILA:	PART NO: U02-5AFXXXT-004-V1	SIZE: A4
FINSH:	DWG NO: U02-5AFXXXT-004-V1	

REV: A	UNIT mm	SCALE 1=1	QUALITY SYMBOLS	
-----------	------------	--------------	--------------------	--