

RoHS Compliant

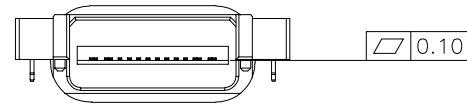

REVISIONS			
REV.	DESCRIPTION	DATE	DESIGN

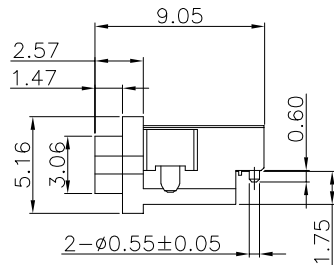
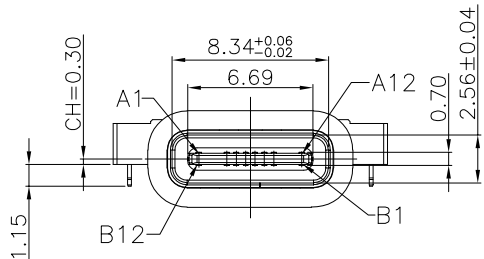
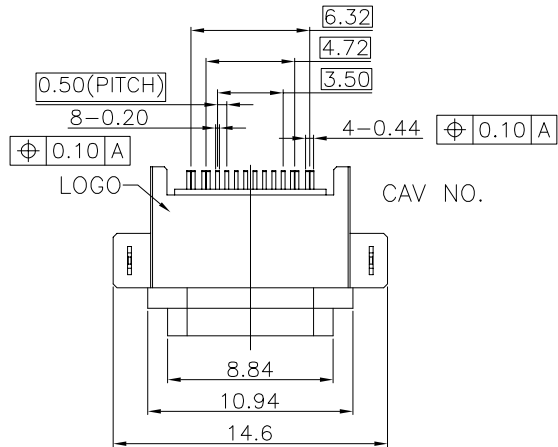

NOTES:

SPECIFICATION:

- CURRENT RATING: 3.0A MAX
- DIELECTRIC WITHSTAND VOLTAGE: 100VAC
- TEMPERATURE RANGE: -30 °C ~ 85 °C
- CONTACT RESISTANCE: 40 MILLIONHM MAX
- INSULATION RESISTANCE: 100 MEGOHMS MIN.
- INSERTION FORCE : 5N~20N
- UNMATING FORCE: 8N~20N
- DURABILITY:10,000 CYCLES

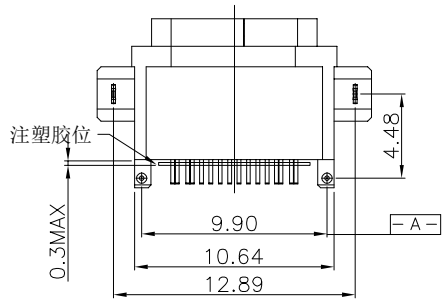

ITEM	PART	NAME	QTY	FINISH	NOTE
3	Shell	1	PA9T (G.F30%)		
2	Contact	5	Phosphor bronze_C5191R-EH Au/Ni Plating T=0.12mm		
1	Housing	1	LCP (G.F30%)		

PART NO. INFORMATION

U06-C F X X 5 R - W101

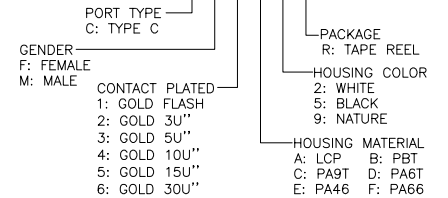

Bestcreate Technology Limited

TOLERANCES UNLESS OTHERWISE SPECIFIED:

X.	± 0.50	X.*	± 5*
.X	± 0.30	.X*	± 2*
.XX	± 0.10	.XX*	± 1*

Website: www.bsc-elec.com
Email: bestcreate@bsc-elec.com

DESIGN: I.L

CHECKED: C.W

APPROVED: C.W

DATE:

DATE:

DATE:

TITLE:

IPX8 WATERPROOF 16P USB C 2.0 FEMALE CONNECTOR SMT TYPE

MATERIAL:

FINISH:

PART NO:

DWG NO:

SIZE: A4

1 OF 2

REV: A

UNIT mm

SCALE 1=1

QUALITY SYMBOLS

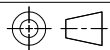

RoHS Compliant

REVISIONS			
REV.	DESCRIPTION	DATE	DESIGN

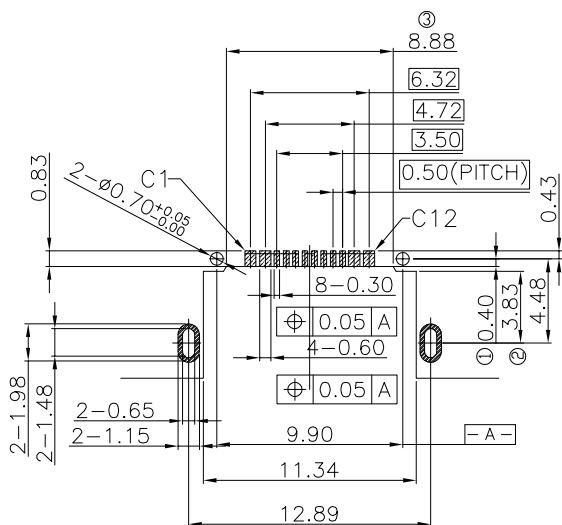

①②③ 加工时确保加工到位, 未到位会影响座子落板
RECOMMENDED PCB LAYOUT(TOP VIEW)

THICKNESS T=1.0mm
DEFAULT TOLERANCE+/-0.05

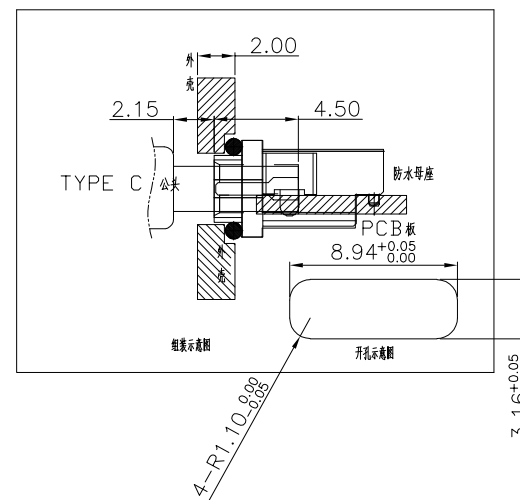
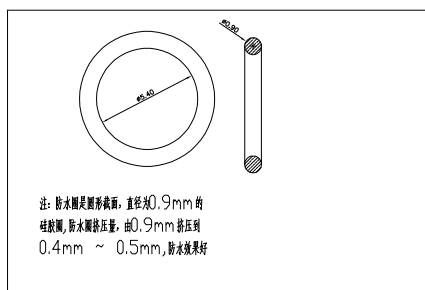

INTERFACE(FRONT VIEW)

A1	A2	A3	A4	A5	A6	A7	A8	A9	A10	A11	A12
GND			VBUS	CC1	DP1	DN1	SBU1	VBUS			GND
GND			VBUS	SBU2	DN2	DP2	CC2	VBUS			GND
B12	B11	B10	B9	B8	B7	B6	B5	B4	B3	B2	B1

PIN ASSIGNMENT

PIN NO.	A1&B12	A4&B9	B8	A5	B7	A6	A7	B6	A8	B5	A9&B4	A12&B1
SIGNAL NAME	GND	VBUS	SBU2	CC1	DN2	DP1	DN1	DP2	SBU1	CC2	VBUS	GND
PCB PAD NO.	C1	C2	C3	C4	C5	C6	C7	C8	C9	C10	C11	C12

Bestcreate Technology Limited

TOLERANCES UNLESS OTHERWISE SPECIFIED:

X.	± 0.50	X.*	± 5°
.X	± 0.30	.X*	± 2°
.XX	± 0.10	.XX*	± 1°

Website: www.bsc-elec.com
Email: bestcreate@bsc-elec.com

DESIGN: I.L DATE:

CHECKED: C.W DATE:

APPROVED: C.W DATE:

TITLE: IPX8 WATERPROOF 16P USB C 2.0 FEMALE CONNECTOR SMT TYPE

MATERIAL:	PART NO: U06-CFXX5R-W119	SIZE: A4
FINISH:	DWG NO: U06-CFXX5R-W119	2 OF 2

REV: A	UNIT mm	SCALE 1=1	QUALITY SYMBOLS
--------	---------	-----------	-----------------