

RoHS Compliant

REVISIONS			
REV.	DESCRIPTION	DATE	DESIGN

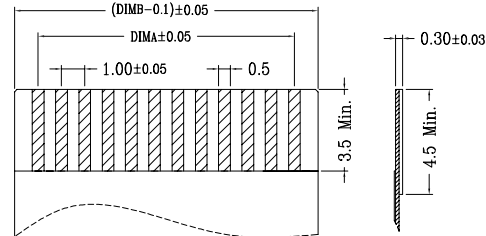

通用扁平线 (Applicable Flat Cable)

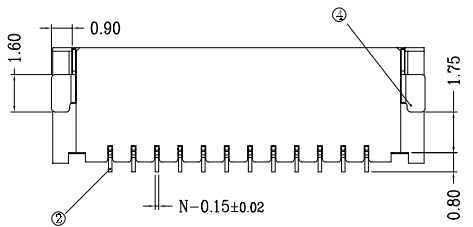
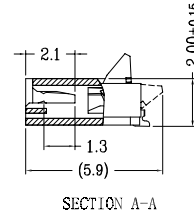
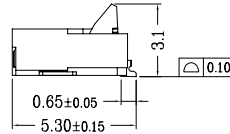
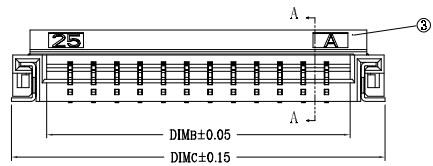
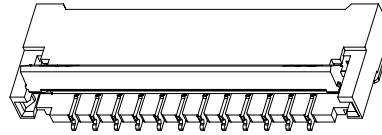
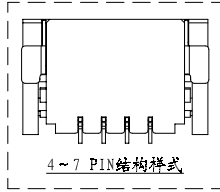
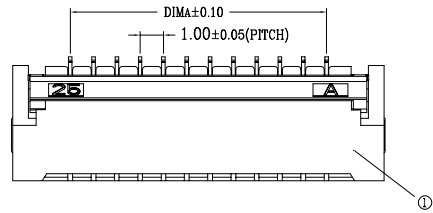
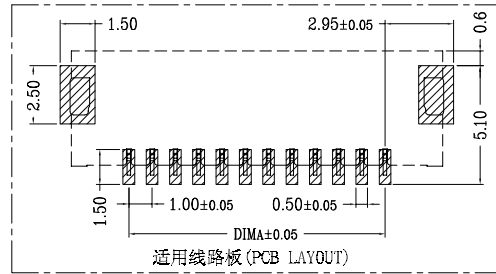

适用线路板 (PCB LAYOUT)

序号	品名	材质
①	0.0后压嵌芯 (12.0)	LCP UL94V-0 本色
②	0.8后压端子 (12.0)	铜合金/表面镀锡 镀金
③	0.8后压后盖 (12.0)	LCP UL94V-0 黑色
④	0.8后压垫片 (12.0)	铜合金/表面镀锡

CKT	DIMA	DIMB	DIMC
4	3.00	5.02	8.04
5	4.00	6.02	9.04
6	5.00	7.02	10.04
7	6.00	8.02	11.04
8	7.00	9.02	12.04
9	8.00	10.02	13.04
10	9.00	11.02	14.04
11	10.00	12.02	15.04
12	11.00	13.02	16.04
13	12.00	14.02	17.04
14	13.00	15.02	18.04
15	14.00	16.02	19.04
16	15.00	17.02	20.04
17	16.00	18.02	21.04
18	17.00	19.02	22.04
19	18.00	20.02	23.04
20	19.00	21.02	24.04
21	20.00	22.02	25.04
22	21.00	23.02	26.04
23	22.00	24.02	27.04
24	23.00	25.02	28.04
25	24.00	26.02	29.04
26	25.00	27.02	30.04
27	26.00	28.02	31.04
28	27.00	29.02	32.04
29	28.00	30.02	33.04
30	29.00	31.02	34.04

技术指标:

1. 塑件表面应光洁、无毛边、无明显收缩、缺陷、裂纹等现象。
2. 温度范围: -25° C~85° C.
3. 额定电压: 50V, AC/DC(等效).
4. 接触电阻: ≤0.03Ω.
5. 绝缘电阻: ≥500MΩ

PART NO. INFORMATION

**FPC10-XX G 1 X - B008**

NO. OF CONTACTS: 1  
 PLATING: G  
 PACKAGE: T-TUBE  
 R-TAPE&REEL  
 1:ROHS  
 2: HALOGEN FREE

**Bestcreate Technology Limited**

TOLERANCES UNLESS OTHERWISE SPECIFIED:

.X	± 0.50	.X'	± 2'
.XX	± 0.20	.X''	± 1'
.XXX	± 0.05	.X'''	± 0.5'

Website: www.bsc-elec.com  
 Email: bestcreate@bsc-elec.com

DESIGN: I. L  
 CHECKED: C. W  
 APPROVED: C. W  
 DATE: 2017. 3. 1

TITLE: 1.0MM FPC BACK LOCK HORIZONTAL TYPE, H:2.0MM  
 MATERILA: FPC10-XXG1X-B008  
 FINSH: FPC10-XXG1X-B008  
 PART NO: FPC10-XXG1X-B008  
 SIZE: A4  
 DWG NO: FPC10-XXG1X-B008

REV: A  
 UNIT: mm  
 SCALE: 1=1  
 QUALITY SYMBOLS