

RoHS Compliant

REVISIONS			
REV.	DESCRIPTION	DATE	DESIGN

A
B
C
D

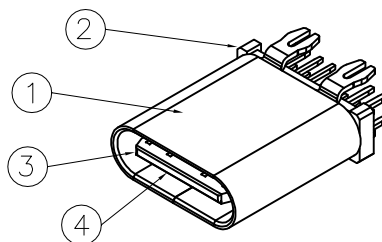
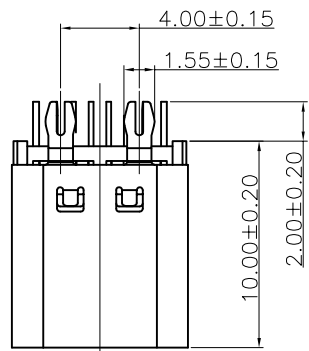

- ELECTRICAL:**
CURRENT:5A
CONTACT RESISTANCE:40 MILLIOHMS MAX
DIELECTRIC WITHSTANDING VOLTAGE: 200V AC
INSULATION RESISTANCE:100 MEGOHMS MIN
- MECHANICAL:**
MATING FORCE:5-20N
WITHDRAWAL FORCE:8-20N
DURBILITY:10000 CYCLES
- ENVIRONMENTAL:**
TEMPERTURE RANGE -40℃~105℃
SALT TESTING:24 HOURS

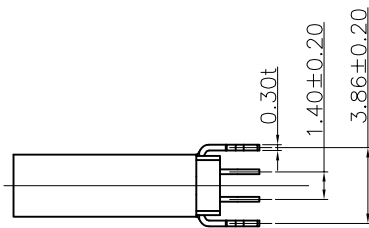
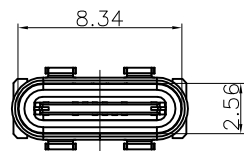
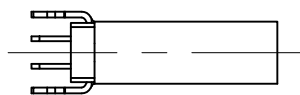

PART NO. INFORMATION

U06-C F X X 5 R - 046

- PORT TYPE
C: TYPE C
- GENDER
F: FEMALE
M: MALE
- CONTACT PLATED
1: GOLD FLASH
2: GOLD 3U"
3: GOLD 5U"
4: GOLD 10U"
5: GOLD 15U"
6: GOLD 30U"
- PACKAGE
R: TAPE REEL
- HOUSING COLOR
2: WHITE
5: BLACK
9: NATURE
- HOUSING MATERIAL
A: LCP B: PBT
C: PA9T D: PA6T
E: PA46 F: PA66

A1	GND	B12	GND
A4	VBUS	B9	VBUS
A5	CC1	B8	SDI2
A6	DP1	B7	DMC
A7	DM1	B6	DP2
A8	SDU1	B5	CC2
A9	VBUS	B4	VBUS
A12	GND	B1	GND
PIN	SIGNAL NAME	PIN	SIGNAL NAME

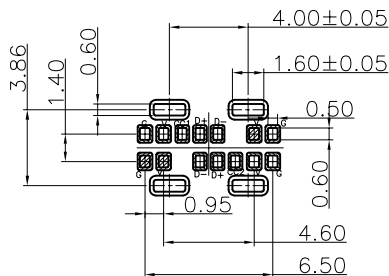
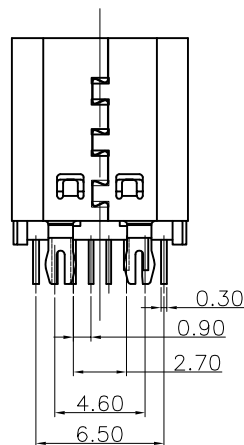

RECOMMENDED P.C.B. LAYOUT
TOLERANCE UNSPECIFIED ±0.05mm

NO.	DESCRIPTION	MATERIAL	REMARKS	QTY
3	MD	STAINLESS STEEL		1SET
2	CONTACT	HIGH TEMPERATURE PLASTIC	BLACK	1PCS
1	HOUSING	COPPER ALLOY	Au/Ni Plated	1PCS
		HIGH TEMPERATURE PLASTIC	BLACK	1PCS

Bestcreate Technology Limited

REV: A UNIT mm SCALE 1=1 QUALITY SYMBOLS

TOLERANCES UNLESS OTHERWISE SPECIFIED:
 X. ± 0.30 X.* ± 5'
 .X ± 0.15 .X.* ± 2'
 .XX ± 0.10 .XX.* ± 1'
 Website:www.bsc-elec.com
 Email:bestcreate@bsc-elec.com

DESIGN: I. L DATE: CHECKED: C. W DATE: APPROVED: C. W DATE:

TITLE: **USB C FEMALE 14PIN CONNECTOR 180D**
 MATERILA: PART NO: U06-CFXX5R-046 SIZE: A4
 FINSH: DWG NO: U06-CFXX5R-046

1 2 3 4 5 6 7 8